

NOTES: See Tabulated Sheet

- 1 Relief permits component shafts to near butt.
- 2 Hubs and HELI-CAL FLEXURE are made from a single piece of material.
- 3 Integral Clamp attachment, hex. socket, cap screw furnished: both hubs.
- 4 Backlash: None. No lubrication required.
- 5 Permitted axial motion from free length:  $\pm .008$ in.
- 6 RPM: Up to 10,000, depending upon application.
- 7 Working torque ratings are based upon continuous duty with noted misalignments applied separately and may be increased with improved alignment:
- See Tabulated Sheet
- 8 Permissible shaft misalignment:  
Angular, up to 3 degrees.  
Offset, up to .010in.  
(TIR, .020in.)
- 9 Part will have a 1.428in. Clearance Diameter on both ends when any bore is over .447in. thru .630in. or a 1.465in. Clearance Diameter when any bore is over .630in. thru .669in.

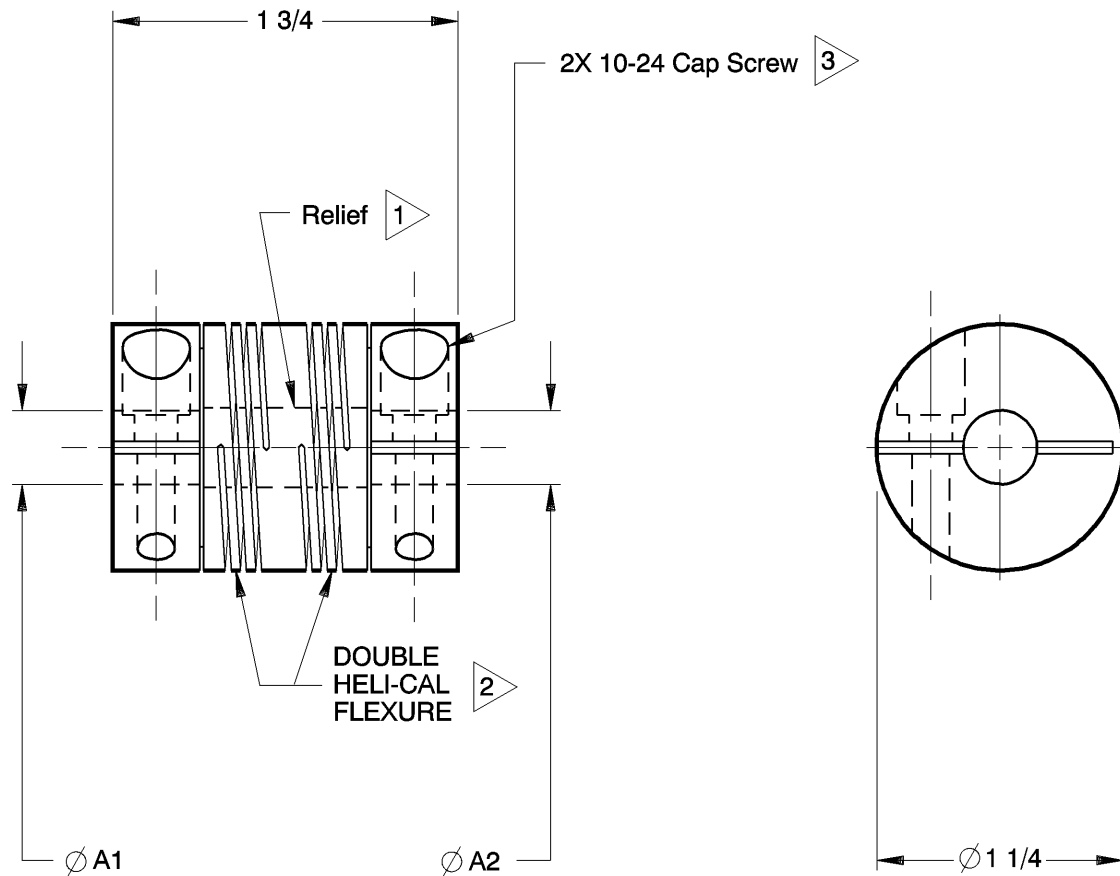

DSAC125-12-12 SHOWN

NOTICE: THE INFORMATION AND DATA CONTAINED HEREIN IS CONSIDERED PROPRIETARY TO HELICAL PRODUCTS COMPANY, INC., AND SHALL REMAIN THE EXCLUSIVE PROPERTY OF HELICAL. THE HOLDER WILL ASSUME CUSTODY AND CONTROL THAT THIS DOCUMENT WILL NOT BE COPIED, REPRODUCED OR DISCLOSED WITHOUT THE EXPRESS WRITTEN CONSENT OF HELICAL. POSSESSION OF THIS DOCUMENT DOES NOT CONSTITUTE A GRANT TO MANUFACTURE ANY ITEMS.

DO NOT SCALE DRAWING.

01-25-10	---	Finish was Chromic Acid Anodize; Updated GD&T	HG	JAJ	Unless otherwise noted dimensions in inches. Inch Fractions: $\pm 1/64$ Decimals: .XX $\pm .010$ .XXX $\pm .005$ .XXXX $\pm .0010$ Metric Decimals: X $\pm 0.5$ mm X.X $\pm 0.25$ mm X.XX $\pm 0.15$ mm Angles: $\pm 2$ degrees Break sharp corners .010 max.	APPROVALS	DATE	<b>HELICAL PRODUCTS CO., INC.</b> P.O. BOX 1069 SANTA MARIA, CA. 93456 U.S.A PHONE (805) 928-3851 FSC13201
						DRAWN	BJM 6-29-89	
						CHECKED	MC 7-6-89	
						PRODN	DH 7-11-89	
ISSUED		TITLE	HELICAL FLEXIBLE SHAFT COUPLING					
WEIGHT	83g (calc)	MATERIAL	7075-T6 Aluminum Alloy					
SCALE	1/1	FINISH	Anodize per HPS1000					
DATE	LTR	REVISION	CHK	DWG NO	DSAC125	SIZE	A	

ADDITION DATE	PART NUMBER	BORE TOLERANCES		TORQUES (lbin)			TORSIONAL FLEXIBILITY deg/lbin	MASS MOMENT OF INERTIA	COMMENTS	A1	A2	
		+.002in -.000in	or	+.05mm -.00mm	Non-reversing	Shock or Reversing						Momentary
08 Nov 89	DSAC125-10-6	.313in		.188in	30	15	61	.062				
	DSAC125-10-8	.313in		.250in	30	15	61	.062				
	DSAC125-10-10	.313in		.313in	30	15	61	.062				
07 Dec 01	DSAC125-12-6	.375in		.188in	29	14	58	.08				
19 Jun 02	DSAC125-12-5mm	.375in		5.00mm	29	15	58	.08				
	DSAC125-12-6mm	.375in		6.00mm	29	14	58	.08				
04 May 90	DSAC125-12-8	.375in		.250in	29	14	58	.08				
23 Mar 04	DSAC125-12-7mm	.375in		7.00mm	29	14	58	.08				
	DSAC125-12-10	.375in		.313in	29	14	58	.08				
	DSAC125-12-8mm	.375in		8.00mm	29	14	58	.08				
04 Dec 89	DSAC125-12-12	.375in		.375in	29	14	58	.08				
21 Dec 07	DSAC125-12-10mm	.375in		10.00mm	29	14	58	.08				
	DSAC125-10mm-8	10.00mm		.250in	29	14	58	.08				
	DSAC125-10mm-12	10.00mm		.375in	29	14	58	.08				
	DSAC125-13-12	.407in		.375in	27	14	55	.09				
	DSAC125-11mm-8	11.00mm		.250in	26	13	53	.1				
	DSAC125-11mm-13	11.00mm		.407in	26	13	53	.1				

\* NOTE: Bores greater than .630in Dia: bore depth is .450in

NOTICE: THE INFORMATION AND DATA CONTAINED HEREIN IS CONSIDERED PROPRIETARY TO HELICAL PRODUCTS COMPANY, INC., AND SHALL REMAIN THE EXCLUSIVE PROPERTY OF HELICAL. THE HOLDER WILL ASSUME CUSTODY AND CONTROL THAT THIS DOCUMENT WILL NOT BE COPIED, REPRODUCED OR DISCLOSED WITHOUT THE EXPRESS WRITTEN CONSENT OF HELICAL. POSSESSION OF THIS DOCUMENT DOES NOT CONSTITUTE A GRANT TO MANUFACTURE ANY ITEMS.

**ADDITIONAL BORE SIZES AVAILABLE UPON REQUEST**

APPROVALS	DATE
DRAWN	
CHECKED	
PRODN	
ISSUED	1/18/2012 10:10:22 AM

HELICAL PRODUCTS CO. INC  
P.O. BOX 1069 SANTA MARIA, CA. 93456 U.S.A  
PHONE (805) 928-3851 FSCI320I

TITLE **HELICAL FLEXIBLE SHAFT COUPLING**

**TABULATED BORE SIZES**

DWG NO **DSAC125**

Printed 1/18/2012 10:12:08 AM by larryg

ADDITION DATE	PART NUMBER	BORE TOLERANCES		TORQUES (lbin)			TORSIONAL FLEXIBILITY deg/lbin	MASS MOMENT OF INERTIA	COMMENTS	A1	A2
		+.002in -.000in	or +.05mm -.00mm	Non-reversing	Shock or Reversing	Momentary					
01 May 06	DSAC125-14-8	.438in	.250in	26	13	53	.109				
07 Dec 04	DSAC125-14-10	.438in	.313in	26	13	53	.109				
04 Aug 08	DSAC125-14-12	.438in	.375in	26	13	53	.109				
17 Apr 02	DSAC125-12mm-8	12.00mm	.250in	25	12	50	.11	Clearance Diam.:	1.428in		
	DSAC125-12mm-10	12.00mm	.313in	25	12	50	.11	Clearance Diam.:	1.428in		
	DSAC125-12mm-12	12.00mm	.375in	25	12	50	.11	Clearance Diam.:	1.428in		
18 Jan 12	DSAC125-12mm-11mm	12.00mm	11.00mm	25	12	50	.11	Clearance Diam.:	1.428in		
21 Nov 03	DSAC125-12mm-12mm	12.00mm	12.00mm	25	13	50	.11	Clearance Diam.:	1.428in		
	DSAC125-16-6	.500in	.188in	23	12	47	.12	Clearance Diam.:	1.428in		
	DSAC125-16-5mm	.500in	5.00mm	23	12	47	.12	Clearance Diam.:	1.428in		
16 Jan 02	DSAC125-16-6mm	.500in	6.00mm	23	12	47	.12	Clearance Diam.:	1.428in		
	DSAC125-16-8	.500in	.250in	23	12	47	.12	Clearance Diam.:	1.428in		
08 Nov 89	DSAC125-16-10	.500in	.313in	23	12	47	.12	Clearance Diam.:	1.428in		
	DSAC125-16-8mm	.500in	8.00mm	23	12	47	.12	Clearance Diam.:	1.428in		
31 Aug 00	DSAC125-16-9mm	.500in	9.00mm	23	12	47	.12	Clearance Diam.:	1.428in		
26 Jan 90	DSAC125-16-12	.500in	.375in	23	12	47	.12	Clearance Diam.:	1.428in		
	DSAC125-16-10mm	.500in	10.00mm	23	12	47	.12	Clearance Diam.:	1.428in		
	DSAC125-16-11mm	.500in	11.00mm	23	12	47	.12	Clearance Diam.:	1.428in		
27 Sep 01	DSAC125-16-14	.500in	.438in	23	12	47	.12	Clearance Diam.:	1.428in		
	DSAC125-16-11.43mm	.500in	11.43mm	23	12	47	.12	Clearance Diam.:	1.428in		
	DSAC125-16-12mm	.500in	12.00mm	23	12	47	.12	Clearance Diam.:	1.428in		
08 Nov 89	DSAC125-16-16	.500in	.500in	23	12	47	.12	Clearance Diam.:	1.428in		
05 Apr 02	DSAC125-13mm-8	13.00mm	.250in	23	12	46	.12	Clearance Diam.:	1.428in		
	DSAC125-14mm-8	14.00mm	.250in	22	11	44	.12	Clearance Diam.:	1.428in		
	DSAC125-14mm-10	14.00mm	.313in	22	11	44	.12	Clearance Diam.:	1.428in		
10 Sep 01	DSAC125-14mm-12	14.00mm	.375in	22	11	44	.12	Clearance Diam.:	1.428in		
02 Mar 90	DSAC125-14mm-10mm	14.00mm	10.00mm	22	11	44	.12	Clearance Diam.:	1.428in		
	DSAC125-18-12	.563in	.375in	20	10	41	.12	Clearance Diam.:	1.428in		
12 Oct 90	DSAC125-15mm-8	15.00mm	.250in	19	9	38	.19	Clearance Diam.:	1.428in		
	DSAC125-15mm-10	15.00mm	.313in	19	9	38	.19	Clearance Diam.:	1.428in		
	DSAC125-15mm-12	15.00mm	.375in	19	9	38	.19	Clearance Diam.:	1.428in		

\* NOTE: Bores greater than .630in Dia: bore depth is .450in

NOTICE: THE INFORMATION AND DATA CONTAINED HEREIN IS CONSIDERED PROPRIETARY TO HELICAL PRODUCTS COMPANY, INC., AND SHALL REMAIN THE EXCLUSIVE PROPERTY OF HELICAL. THE HOLDER WILL ASSUME CUSTODY AND CONTROL THAT THIS DOCUMENT WILL NOT BE COPIED, REPRODUCED OR DISCLOSED WITHOUT THE EXPRESS WRITTEN CONSENT OF HELICAL. POSSESSION OF THIS DOCUMENT DOES NOT CONSTITUTE A GRANT TO MANUFACTURE ANY ITEMS.

**ADDITIONAL BORE SIZES AVAILABLE UPON REQUEST**

APPROVALS	DATE
DRAWN	
CHECKED	
PRODN	
ISSUED	1/18/2012 10:10:22 AM

HELICAL PRODUCTS CO. INC  
P.O. BOX 1069 SANTA MARIA, CA. 93456 U.S.A  
PHONE (805) 928-3851/FSCI3201

TITLE **HELICAL FLEXIBLE SHAFT COUPLING**

**TABULATED BORE SIZES**

DWG NO **DSAC125**

Printed 1/18/2012 10:12:08 AM by jarrys

ADDITION DATE	PART NUMBER	BORE TOLERANCES		TORQUES (lbin)			TORSIONAL FLEXIBILITY deg/lbin	MASS MOMENT OF INERTIA	COMMENTS	A1	A2		
		+.002in -.000in	or +.05mm -.00mm	Non-reversing	Shock or Reversing	Momentary							
												A1 Dia	A2 Dia
06 Nov 90	DSAC125-20-6	.625in	.188in	17	9	35	.19	Clearance Diam.:	1.428in				
	DSAC125-20-5.95mm	.625in	5.95mm	17	9	35	.19					Clearance Diam.:	1.428in
	DSAC125-20-6mm	.625in	6.00mm	17	9	35	.19					Clearance Diam.:	1.428in
08 Nov 89	DSAC125-20-8	.625in	.250in	17	9	35	.19	Clearance Diam.:	1.428in				
	DSAC125-20-7mm	.625in	7.00mm	17	9	35	.19					Clearance Diam.:	1.428in
	DSAC125-20-10	.625in	.313in	17	9	35	.19					Clearance Diam.:	1.428in
26 Jan 90	DSAC125-20-8mm	.625in	8.00mm	17	9	35	.19	Clearance Diam.:	1.428in				
	DSAC125-20-9mm	.625in	9.00mm	17	9	35	.19					Clearance Diam.:	1.428in
	DSAC125-20-12	.625in	.375in	17	9	35	.19					Clearance Diam.:	1.428in
03 May 90	DSAC125-20-10mm	.625in	10.00mm	17	9	35	.19	Clearance Diam.:	1.428in				
	DSAC125-20-14	.625in	.438in	17	9	35	.19					Clearance Diam.:	1.428in
	DSAC125-20-12mm	.625in	12.00mm	17	9	35	.19					Clearance Diam.:	1.428in
26 Jan 90	DSAC125-20-16	.625in	.500in	17	9	35	.19	Clearance Diam.:	1.428in				
	DSAC125-20-17	.625in	.532in	17	9	35	.19					Clearance Diam.:	1.428in
	DSAC125-20-14mm	.625in	14.00mm	17	9	35	.19					Clearance Diam.:	1.428in
16 Nov 90	DSAC125-20-18	.625in	.563in	17	9	35	.19	Clearance Diam.:	1.428in				
	DSAC125-20-20	.625in	.625in	17	9	35	.19					Clearance Diam.:	1.428in
	DSAC125-15.93mm-12.75mm	15.93mm	12.75mm	17	9	35	.19					Clearance Diam.:	1.428in
12 Mar 02	DSAC125-16mm-6mm	16.00mm	6.00mm	17	9	35	.19	Clearance Diam.:	1.428in				
	DSAC125-16mm-10	16.00mm	.313in	17	9	35	.19					Clearance Diam.:	1.428in
	DSAC125-16mm-8mm	16.00mm	8.00mm	17	9	35	.19					Clearance Diam.:	1.428in
22 Aug 06	DSAC125-16mm-12	16.00mm	.375in	17	9	35	.19	Clearance Diam.:	1.428in				
	DSAC125-16mm-11mm	16.00mm	11.00mm	17	9	35	.19					Clearance Diam.:	1.428in
	DSAC125-16mm-12mm	16.00mm	12.00mm	17	9	35	.19					Clearance Diam.:	1.428in
03 Dec 04	DSAC125-16mm-16	16.00mm	.500in	17	9	35	.19	Clearance Diam.:	1.428in				
	DSAC125-16mm-20	16.00mm	.625in	17	9	35	.19					Clearance Diam.:	1.428in
	DSAC125-16mm-16mm	16.00mm	16.00mm	17	9	35	.19					Clearance Diam.:	1.428in
05 Apr 02	DSAC125-16mm-16mm	16.00mm	16.00mm	17	9	35	.19	Clearance Diam.:	1.428in				
03 May 07	DSAC125-16.98mm-12	*16.98mm	.375in	17	9	35	.19	Clearance Diam.:	1.428in				

\* NOTE: Bores greater than .630in Dia: bore depth is .450in

NOTICE: THE INFORMATION AND DATA CONTAINED HEREIN IS CONSIDERED PROPRIETARY TO HELICAL PRODUCTS COMPANY, INC., AND SHALL REMAIN THE EXCLUSIVE PROPERTY OF HELICAL. THE HOLDER WILL ASSUME CUSTODY AND CONTROL THAT THIS DOCUMENT WILL NOT BE COPIED, REPRODUCED OR DISCLOSED WITHOUT THE EXPRESS WRITTEN CONSENT OF HELICAL. POSSESSION OF THIS DOCUMENT DOES NOT CONSTITUTE A GRANT TO MANUFACTURE ANY ITEMS.

**ADDITIONAL BORE SIZES AVAILABLE UPON REQUEST**

APPROVALS	DATE
DRAWN	
CHECKED	
PRODN	
ISSUED	1/18/2012 10:10:22 AM

HELICAL PRODUCTS CO. INC  
P.O. BOX 1069 SANTA MARIA, CA. 93456 U.S.A  
PHONE (805) 928-3851 FSCI3201

TITLE **HELICAL FLEXIBLE SHAFT COUPLING**

**TABULATED BORE SIZES**

DWG NO **DSAC125**

Printed 1/18/2012 10:12:08 AM by jarrys