

NOTES:

- 1 Restricted bores:  
 MAX shaft penetration:  
 A1 bore- .44  
 A2 bore- .44  
  
 Minimum shaft end to shaft end: 2.00
- 2 Hubs and HELI-CAL FLEXURE are made from a single piece of material.
- 3 Set Screw Attachment, hex socket, ISO std., set screw furnished: both hubs
- 4 Backlash: None.  
 No lubrication required.
- 5 Working torque ratings are based upon continuous duty with noted misalignments applied separately and may be increased with improved alignment:  
 See Tabulated Sheet
- 6 Permissible shaft misalignment:  
 Angular, up to 90 degrees.

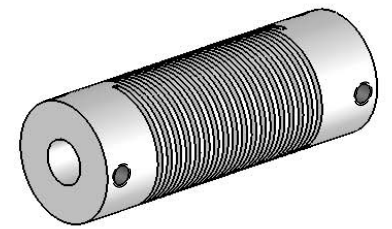
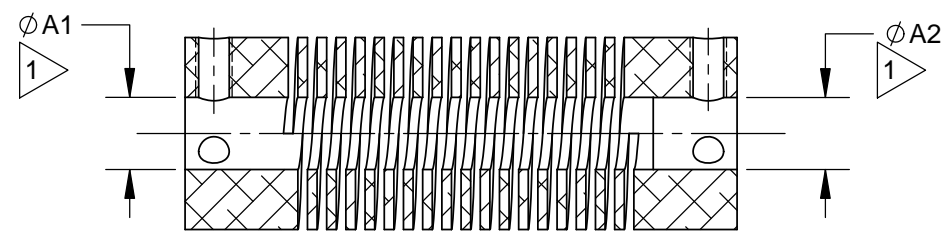
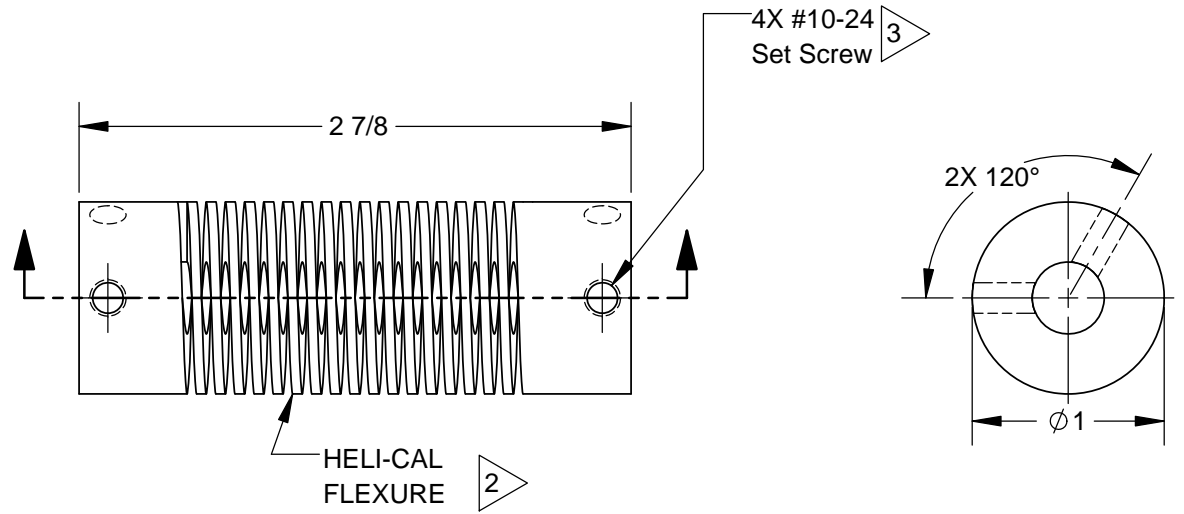

Description: <b>HELICAL FLEXURED U JOINT</b>							
Finish: <b>Natural</b>			Material: <b>7075-T6</b>				
Unless Otherwise Specified All Tolerances & Dimensions are in Inches							
		<b>INCH</b> Angles <b>METRIC</b> X/XX = ± 1/64    ± 2°    X = ± 0.5mm .XX = ± .01    X.X = ± 0.25mm .XXX = ± .005    X.XX = ± 0.15mm		<b>HELICAL</b> PRODUCTS COMPANY 901 West McCoy Lane SANTA MARIA, CA 93456 U.S.A. PHONE (805) 928-3851 FSC13201			
All surface finish 63 roughness Break all sharp corners .010 MAX Interpret IAW ASME Y14.5 2009							
Date		Revision				Drwn., Chk., App.	
MH/08-28-2017		RV/01-10-2018				EK/01-11-2018	
Drawn By/Date		Checked By/Date		Approved By/Date			
				DO NOT SCALE DRAWING   SCALE: 1:1			

NOTICE: THE INFORMATION AND DATA CONTAINED HEREIN IS CONSIDERED PROPRIETARY TO HELICAL PRODUCTS COMPANY, AND SHALL REMAIN THE EXCLUSIVE PROPERTY OF HELICAL. THE HOLDER WILL ASSUME CUSTODY AND CONTROL THAT THIS DOCUMENT WILL NOT BE COPIED, REPRODUCED OR DISCLOSED WITHOUT THE EXPRESS WRITTEN CONSENT OF HELICAL. POSSESSION OF THIS DOCUMENT DOES NOT CONSTITUTE A GRANT TO MANUFACTURE ANY ITEM.  
 Copyright HELICAL PRODUCTS CO.

**TABULATED DATA**  
Copyright HELICAL PRODUCTS CO.

Finish: **Natural**

Material: **7075-T6**

Drawing No.: **UJA100-90**

Sales Sht. No.: **2 of 2** Rev. **A**

DO NOT SCALE DRAWING

DESCRIPTION	BORE SIZES		TORQUES (lbin)		
	TOLERANCE +0.002in or +0.05mm -0.000 0		Momentary Dynamic	Non- Reversing	Shock or Reversing
Ø A1	Ø A2				
UJA100-90-8-8	.250in	.250in	22	11	5.5
UJA100-90-10-10	.313in	.313in	21	10	5.3
UJA100-90-12-12	.375in	.375in	19	9.5	4.9