

NOTES:

- 1 Restricted bores:
 MAX shaft penetration:
 A1 bore- .56
 A2 bore- .56

 Minimum shaft end to shaft end: 1.38
- 2 Hubs and HELI-CAL FLEXURE are made from a single piece of material.
- 3 Set Screw Attachment, hex socket, ISO std., set screw furnished: both hubs
- 4 Backlash: None.
 No lubrication required.
- 5 Working torque ratings are based upon continuous duty with noted misalignments applied separately and may be increased with improved alignment:
 See Tabulated Sheet
- 6 Permissible shaft misalignment:
 Angular, up to 30 degrees.

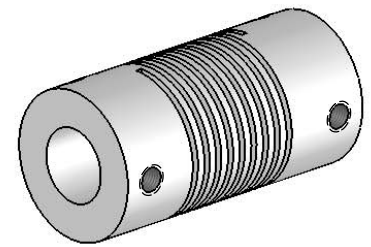
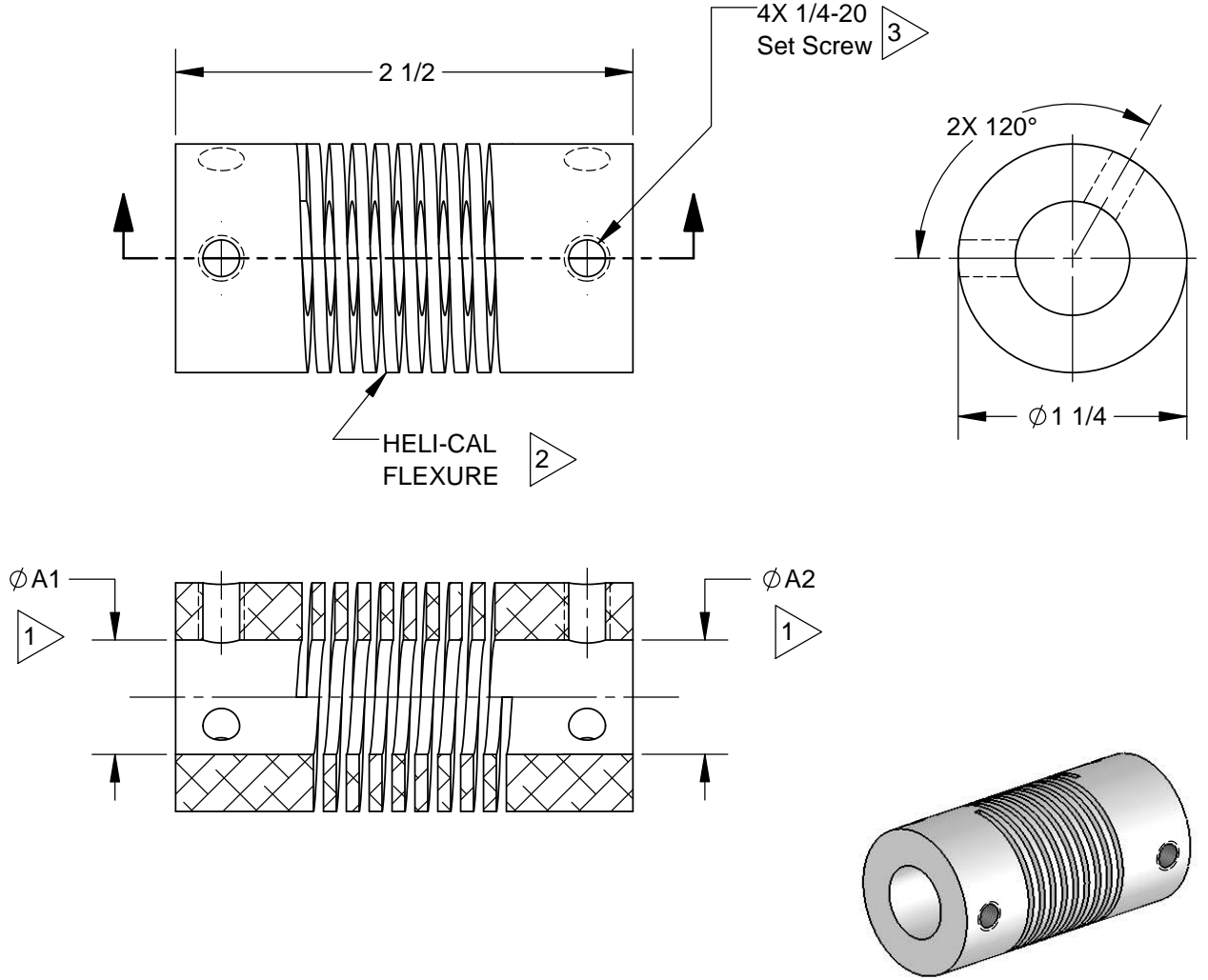

Description: HELICAL FLEXURED U JOINT					
Finish: Natural			Material: 7075-T6		
Unless Otherwise Specified All Tolerances & Dimensions are in Inches INCH Angles METRIC X/XX = ± 1/64 ± 2° X = ± 0.5mm .XX = ± .01 X.X = ± 0.25mm .XXX = ± .005 X.XX = ± 0.15mm					
All surface finish 63 roughness Break all sharp corners .010 MAX Interpret IAW ASME Y14.5 2009					
Date	Ltr.	Revision	Drwn.	Chk.	App.
MH/08-28-2017		BMS/01-18-2018	EK/01-24-2018		
Drawn By/Date		Checked By/Date		Approved By/Date	
				DO NOT SCALE DRAWING SCALE: 1:1	



HELICAL PRODUCTS COMPANY
 901 West McCoy Lane
 SANTA MARIA, CA. 93456 U.S.A.
 PHONE (805) 928-3851 FSC13201

NOTICE: THE INFORMATION AND DATA CONTAINED HEREIN IS CONSIDERED PROPRIETARY TO HELICAL PRODUCTS COMPANY, AND SHALL REMAIN THE EXCLUSIVE PROPERTY OF HELICAL. THE HOLDER WILL ASSUME CUSTODY AND CONTROL THAT THIS DOCUMENT WILL NOT BE COPIED, REPRODUCED OR DISCLOSED WITHOUT THE EXPRESS WRITTEN CONSENT OF HELICAL. POSSESSION OF THIS DOCUMENT DOES NOT CONSTITUTE A GRANT TO MANUFACTURE ANY ITEM.
 Copyright HELICAL PRODUCTS CO.

TABULATED DATA
Copyright HELICAL PRODUCTS CO.

Finish: **Natural**

Material: **7075-T6**

Drawing No.: **UJA125-30**

Sales Sht. No.: **2 of 2** Rev. **A**

DO NOT SCALE DRAWING

DESCRIPTION	BORE SIZES		TORQUES (lbin)		
	TOLERANCE +.002in or +0.05mm -.000 0		Momentary Dynamic	Non- Reversing	Shock or Reversing
Ø A1	Ø A2				
UJA125-30-12-12	.375in	.375in	49	24	12
UJA125-30-16-16	.500in	.500in	40	20	10