

NOTES:

- 1 Refer to Secondary Sheet for Tabulated Data.
- 2  $\phi A1$  and  $\phi A2$  shafts may near butt except:  
When any Bore  $> \phi 16.0$  the component shaft MAX penetration is 15.36.
- 3 Hubs and HELI-CAL FLEXURE are made from a single piece of material.
- 4 Set Screw attachment, hex. socket, ISO std., cup point set screw furnished: both hubs.
- 5 Backlash: None.  
No lubrication required.
- 6 Permitted axial motion from free length:  $\pm 0.25$
- 7 RPM: Up to 10,000, depending on application.
- 8 Working torque ratings are based upon continuous duty with noted misalignments applied separately and may be increased with improved alignment:  
Refer to Tabulated Data
- 9 Permissible shaft misalignment:  
Angular, up to  $5^\circ$   
Offset, up to 0.25 (FIM, 0.50)

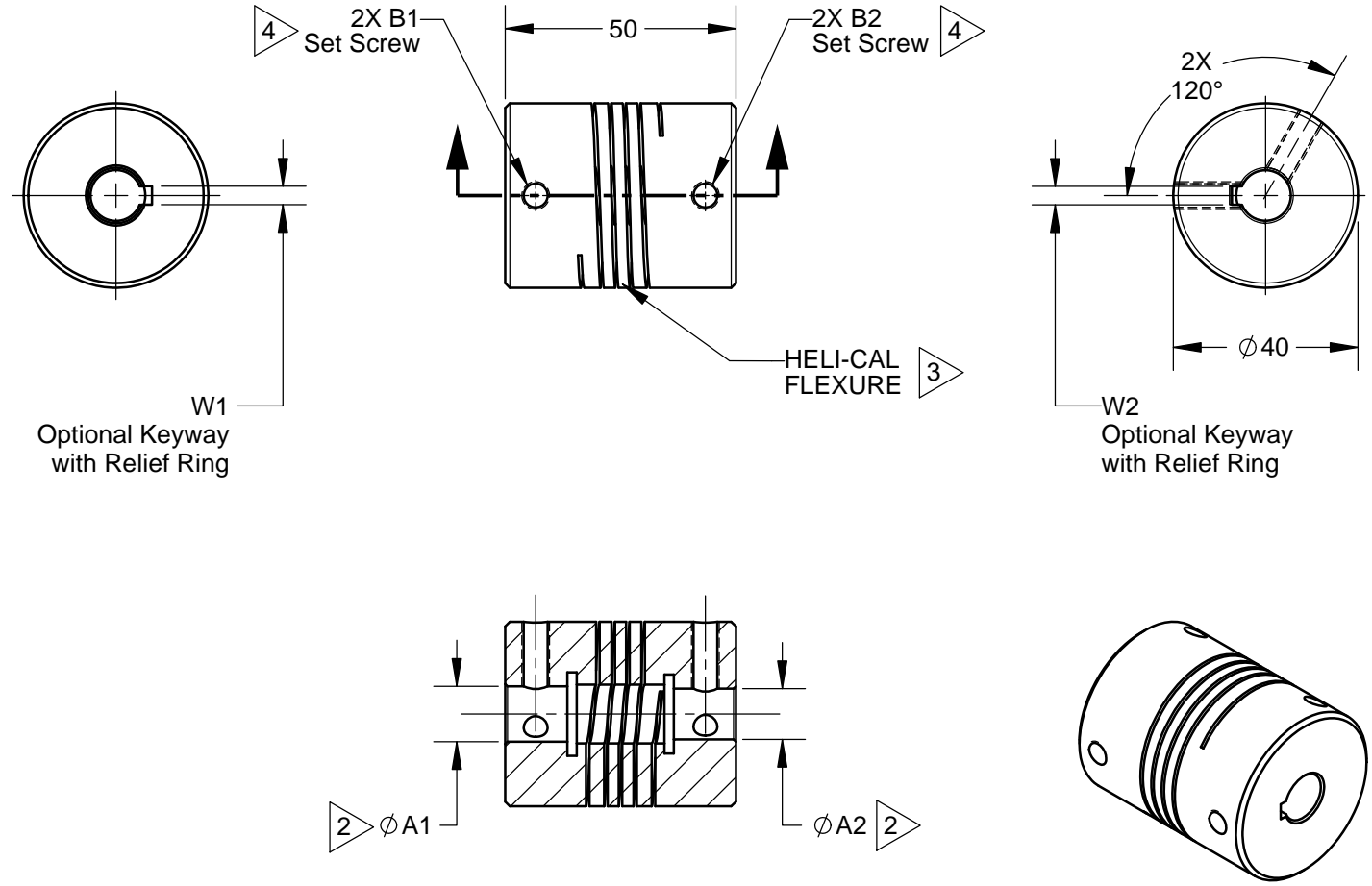

NOTICE: THE INFORMATION AND DATA CONTAINED HEREIN IS CONSIDERED PROPRIETARY TO HELICAL PRODUCTS COMPANY, INC., AND SHALL REMAIN THE EXCLUSIVE PROPERTY OF HELICAL. THE HOLDER WILL ASSUME CUSTODY AND CONTROL THAT THIS DOCUMENT WILL NOT BE COPIED, REPRODUCED OR DISCLOSED WITHOUT THE EXPRESS WRITTEN CONSENT OF HELICAL. POSSESSION OF THIS DOCUMENT DOES NOT CONSTITUTE A GRANT TO MANUFACTURE ANY ITEM.  
Copyright  
HELICAL PRODUCTS CO. INC.

08-08-13	---	Redrawn in Solidworks	CL	JAJ/EK
DATE	LTR	REVISION	APVR	

Unless otherwise specified all tolerances and dimensions are in millimeters.

Inch	Metric
X/XX $\pm$ 1/64	X $\pm$ 0.5mm
.XX $\pm$ .01	X.X $\pm$ 0.25mm
.XXX $\pm$ .005	X.XX $\pm$ 0.15mm
Angles $\pm 2^\circ$	

Break sharp corners .25 MAX  
All surface finish 63 roughness  
Do Not Scale Drawing

		<b>HELICAL PRODUCTS COMPANY</b>		901 West McCoy Lane P.O. BOX 1069 SANTA MARIA, CA. 93456 U.S.A. PHONE (805) 928-3851 FSC13201	
		DRAWN BY <b>BJM</b>	DATE <b>09-02-99</b>	TITLE <b>HELICAL FLEXIBLE SHAFT COUPLING</b>	
CHECKED BY <b>MC</b>	DATE <b>09-20-99</b>	MATL <b>17-4PH CRES HT</b>			
APPRVD BY <b>DH</b>	DATE <b>09-28-99</b>	FINISH <b>Natural</b>			
WEIGHT (calculated) <b>375g</b>		DRAWING NUMBER <b>W740</b>		REV	
SHEET <b>1</b> of <b>2</b>					

