

NOTES: See Tabulated Sheet

- 1 Relief permits component shafts to near butt.
- 2 Hubs and HELI-CAL FLEXURE are made from a single piece of material.
- 3 Integral Clamp attachment, hex. socket, ISO std., cap screw furnished: both hubs.
- 4 Backlash: None. No lubrication required.
- 5 Permitted axial motion from free length:  $\pm .25\text{mm}$ .
- 6 RPM: Up to 10,000, depending upon application.
- 7 Working torque ratings are based upon continuous duty with noted misalignments applied separately and may be increased with improved alignment:  
See Tabulated Sheet
- 8 Permissible shaft misalignment:  
Angular, up to 5 degrees.  
Offset, up to .25mm.  
(TIR, .50mm.)
- 9 Part will have a 34.83mm Clearance Diameter on both ends when any bore is over 12.28mm thru 17.30mm.

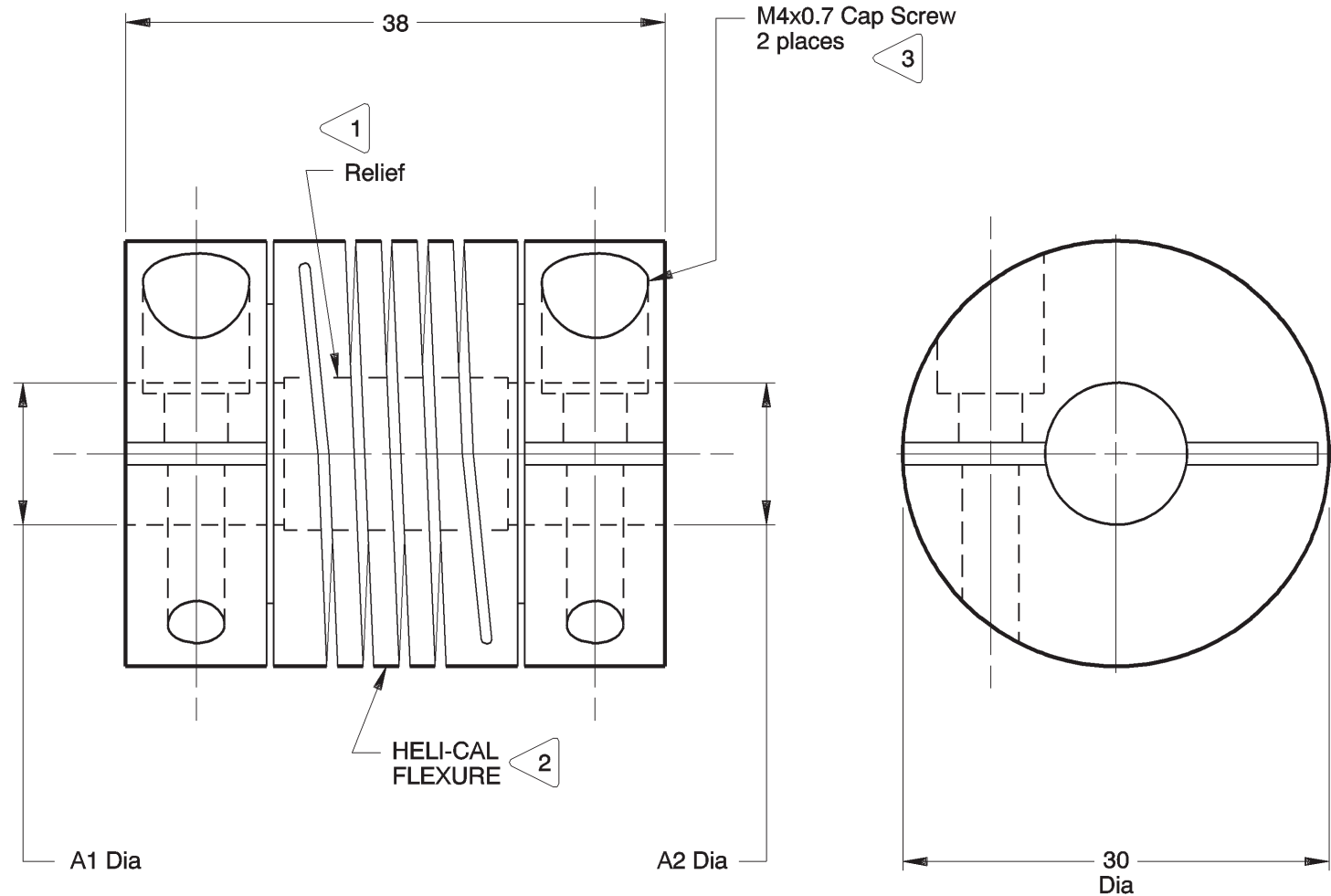

W7C30-10mm-10mm SHOWN

NOTICE: THE INFORMATION AND DATA CONTAINED HEREIN IS CONSIDERED PROPRIETARY TO HELICAL PRODUCTS COMPANY, AND SHALL REMAIN THE EXCLUSIVE PROPERTY OF HELICAL. THE HOLDER WILL ASSUME CUSTODY AND CONTROL THAT THIS DOCUMENT WILL NOT BE COPIED, REPRODUCED OR DISCLOSED WITHOUT THE EXPRESS WRITTEN CONSENT OF HELICAL. POSSESSION OF THIS DOCUMENT DOES NOT CONSTITUTE A GRANT TO MANUFACTURE ANY ITEMS.

DO NOT SCALE DRAWING.

9-14-98		Clerical format update/ No revision	BJM	MC
DATE	LTR	REVISION	CHK	

Unless otherwise noted dimensions in millimeters.

Tolerances are:  
Decimals: X  $\pm .5\text{mm}$   
          X.X  $\pm .25\text{mm}$   
          X.XX  $\pm .15\text{mm}$   
Angles:  $\pm 2$  degrees  
Break sharp corners  
.25mm max.

APPROVALS	DATE
DRAWN MM	8-11-78
CHECKED GLB	8-11-78
PRODN APA	8-11-78
ISSUED	
WEIGHT 167g (calc)	
SCALE 2/1	SIZE A

<b>HELICAL PRODUCTS CO.</b>	
P.O. BOX 1069 SANTA MARIA, CA. 93456 U.S.A PHONE (805) 928-3851 FSC13201	
TITLE	HELICAL FLEXIBLE SHAFT COUPLING
MATERIAL	17-4PH CRES HT
FINISH	Natural
DWG NO	W7C30

ADDITION DATE	PART NUMBER	BORE TOLERANCES		TORQUES ( Nm )			TORSIONAL FLEXIBILITY deg/Nm	MASS MOMENT OF INERTIA	COMMENTS	A1	A2
		+.002in -.000in	or +.05mm -.00mm	Non-reversing	Shock or Reversing	Momentary					
		A1 Dia	A2 Dia								
09 Mar 88	W7C30-6mm-6mm Superseded	6.00mm	6.00mm	.00	.00	.00					
09 Mar 88	W7C30-8-5mm Superseded	.250in	5.00mm	.00	.00	.00					
09 Mar 88	W7C30-8-8 Superseded	.250in	.250in	.00	.00	.00					
11 Jan 01	W7C30-8mm-9mm Superseded	8.00mm	9.00mm	.00	.00	.00					
	W7C30-9mm-8	9.00mm	.250in	4.8	2.4	9.5					
	W7C30-9mm-7.5mm	9.00mm	7.50mm	4.8	2.4	9.5					
09 Mar 88	W7C30-9mm-8mm	9.00mm	8.00mm	4.8	2.4	9.5					
09 Mar 88	W7C30-9mm-9mm	9.00mm	9.00mm	4.8	2.4	9.5					
14 Apr 08	W7C30-9mm-11mm	9.00mm	11.00mm	4.8	2.4	9.5					
17 Jun 10	W7C30-9.3mm-7mm	9.30mm	7.00mm	4.8	2.4	9.6					
13 Oct 08	W7C30-9.4mm-8mm	9.40mm	8.00mm	4.6	2.3	9.1					
	W7C30-9.5mm-5mm	9.50mm	5.00mm	4.6	2.3	9.2					
09 Mar 88	W7C30-9.5mm-9mm	9.50mm	9.00mm	4.6	2.3	9.2					
	W7C30-9.5mm-9.5mm	9.50mm	9.50mm	4.6	2.3	9.2					
09 Mar 88	W7C30-9.5mm-10mm	9.50mm	10.00mm	4.5	2.2	8.9					
09 Mar 88	W7C30-12-6mm	.375in	6.00mm	4.6	2.3	9.2					
	W7C30-12-10	.375in	.313in	4.6	2.3	9.2					
	W7C30-12-8mm	.375in	8.00mm	4.6	2.3	9.2					
	W7C30-12-11	.375in	.344in	4.6	2.3	9.2					
09 Mar 88	W7C30-12-9mm	.375in	9.00mm	4.6	2.3	9.2					
09 Mar 88	W7C30-12-12	.375in	.375in	4.6	2.3	9.2					
	W7C30-10mm-3mm	10.00mm	3.00mm	4.5	2.2	8.9					
	W7C30-10mm-4mm	10.00mm	4.00mm	4.5	2.2	8.9					
06 Apr 01	W7C30-10mm-5mm	10.00mm	5.00mm	4.5	2.2	8.9					
09 Mar 88	W7C30-10mm-6mm	10.00mm	6.00mm	4.5	2.2	8.9					
09 Mar 88	W7C30-10mm-8	10.00mm	.250in	4.5	2.2	8.9					

\* NOTE: Bores greater than 12.70mmDia: bore depth is 1.00mm

NOTICE: THE INFORMATION AND DATA CONTAINED HEREIN IS CONSIDERED PROPRIETARY TO HELICAL PRODUCTS COMPANY, AND SHALL REMAIN THE EXCLUSIVE PROPERTY OF HELICAL. THE HOLDER WILL ASSUME CUSTODY AND CONTROL THAT THIS DOCUMENT WILL NOT BE COPIED, REPRODUCED OR DISCLOSED WITHOUT THE EXPRESS WRITTEN CONSENT OF HELICAL. POSSESSION OF THIS DOCUMENT DOES NOT CONSTITUTE A GRANT TO MANUFACTURE ANY ITEMS.

**ADDITIONAL BORE SIZES AVAILABLE UPON REQUEST**

APPROVALS	DATE	HELICAL PRODUCTS CO. P.O. BOX 1069 SANTA MARIA, CA. 93456 U.S.A PHONE (805) 928-3851 FSCI3201 <b>TITLE HELICAL FLEXIBLE SHAFT COUPLING</b> <b>TABULATED BORE SIZES</b> DWG NO W7C30
DRAWN		
CHECKED		
PRODN		
ISSUED	6/15/2012 9:54:54 AM	

Printed 6/15/2012 9:57:18 AM by larryvg

ADDITION DATE	PART NUMBER	BORE TOLERANCES		TORQUES ( Nm )			TORSIONAL FLEXIBILITY deg/Nm	MASS MOMENT OF INERTIA	COMMENTS	A1	A2
		+.002in -.000in	or +.05mm -.00mm	Non-reversing	Shock or Reversing	Momentary					
09 Mar 88	W7C30-10mm-7mm	10.00mm	7.00mm	4.5	2.2	8.9					
09 Oct 00	W7C30-10mm-7.5mm	10.00mm	7.50mm	4.5	2.2	8.9					
02 May 88	W7C30-10mm-8mm	10.00mm	8.00mm	4.5	2.2	8.9					
31 Mar 11	W7C30-10mm-8.1mm	10.00mm	8.10mm	4.5	2.2	8.9					
09 Mar 88	W7C30-10mm-9mm	10.00mm	9.00mm	4.5	2.2	8.9					
09 Mar 88	W7C30-10mm-9.5mm	10.00mm	9.50mm	4.5	2.2	8.9					
09 Mar 88	W7C30-10mm-12	10.00mm	.375in	4.5	2.2	8.9					
09 Mar 88	W7C30-10mm-10mm	10.00mm	10.00mm	4.5	2.2	8.9					
	W7C30-11mm-6mm	11.00mm	6.00mm	4.2	2.1	8.3					
09 Mar 88	W7C30-11mm-8	11.00mm	.250in	4.2	2.1	8.3					
09 Mar 88	W7C30-11mm-8mm	11.00mm	8.00mm	4.2	2.1	8.3					
09 Mar 88	W7C30-11mm-9mm	11.00mm	9.00mm	4.2	2.1	8.3					
	W7C30-11mm-9.5mm	11.00mm	9.50mm	4.2	2.1	8.3					
02 May 88	W7C30-11mm-12	11.00mm	.375in	4.2	2.1	8.3					
09 Mar 88	W7C30-11mm-10mm	11.00mm	10.00mm	4.2	2.1	8.3					
09 Mar 88	W7C30-11mm-11mm	11.00mm	11.00mm	4.2	2.1	8.3					
02 May 88	W7C30-11.5mm-11.5mm	11.50mm	11.50mm	4.0	2.0	8.0					
	W7C30-11.6mm-11.6mm	11.60mm	11.60mm	4.0	2.0	8.0					
02 May 88	W7C30-12mm-3mm	12.00mm	3.00mm	3.9	1.9	7.7					
	W7C30-12mm-5mm	12.00mm	5.00mm	3.9	1.9	7.7					
09 Mar 88	W7C30-12mm-6mm	12.00mm	6.00mm	3.9	1.9	7.7					
02 May 88	W7C30-12mm-8	12.00mm	.250in	3.9	1.9	7.7					
27 Jun 06	W7C30-12mm-7mm	12.00mm	7.00mm	3.9	1.9	7.7					
	W7C30-12mm-10	12.00mm	.313in	3.9	1.9	7.7					
09 Mar 88	W7C30-12mm-8mm	12.00mm	8.00mm	3.9	1.9	7.7					
09 Mar 88	W7C30-12mm-9mm	12.00mm	9.00mm	3.9	1.9	7.7					
09 Mar 88	W7C30-12mm-9.5mm	12.00mm	9.50mm	3.9	1.9	7.7					
09 Mar 88	W7C30-12mm-12	12.00mm	.375in	3.9	1.9	7.7					
	W7C30-12mm-9.9mm	12.00mm	9.90mm	3.9	1.9	7.7					
09 Mar 88	W7C30-12mm-10mm	12.00mm	10.00mm	3.9	1.9	7.7					
09 Mar 88	W7C30-12mm-11mm	12.00mm	11.00mm	3.9	1.9	7.7					

\* NOTE: Bores greater than 12.70mm Dia: bore depth is 1.00mm

NOTICE: THE INFORMATION AND DATA CONTAINED HEREIN IS CONSIDERED PROPRIETARY TO HELICAL PRODUCTS COMPANY, AND SHALL REMAIN THE EXCLUSIVE PROPERTY OF HELICAL. THE HOLDER WILL ASSUME CUSTODY AND CONTROL THAT THIS DOCUMENT WILL NOT BE COPIED, REPRODUCED OR DISCLOSED WITHOUT THE EXPRESS WRITTEN CONSENT OF HELICAL. POSSESSION OF THIS DOCUMENT DOES NOT CONSTITUTE A GRANT TO MANUFACTURE ANY ITEMS.

**ADDITIONAL BORE SIZES AVAILABLE UPON REQUEST**

APPROVALS	DATE	HELICAL PRODUCTS CO. P.O. BOX 1069 SANTA MARIA, CA. 93456 U.S.A PHONE (805) 928-3851 FSCI3201 <b>TITLE HELICAL FLEXIBLE SHAFT COUPLING</b> <b>TABULATED BORE SIZES</b> DWG NO W7C30
DRAWN		
CHECKED		
PRODN		
ISSUED	6/15/2012 9:54:54 AM	

Printed 6/15/2012 9:57:18 AM by Larryvg

ADDITION DATE	PART NUMBER	BORE TOLERANCES		TORQUES ( Nm )			TORSIONAL FLEXIBILITY	MASS MOMENT OF INERTIA	COMMENTS	A1	A2	
		+.002in -.000in	or +.05mm -.00mm	Non-reversing	Shock or Reversing	Momentary						deg/Nm
09 Mar 88	W7C30-12mm-12mm	12.00mm	12.00mm	3.9	1.9	7.7						
15 Jun 12	W7C30-12mm-16mm	12.00mm	*16.00mm	3.9	1.9	7.7						
09 Mar 88	W7C30-16-8	.500in	.250in	3.7	1.8	7.3		Clearance Diam.:		34.83mm		
09 Mar 88	W7C30-16-8mm	.500in	8.00mm	3.7	1.8	7.3		Clearance Diam.:		34.83mm		
02 May 88	W7C30-16-12	.500in	.375in	3.7	1.8	7.3		Clearance Diam.:		34.83mm		
18 Oct 88	W7C30-16-10mm	.500in	10.00mm	3.7	1.8	7.3		Clearance Diam.:		34.83mm		
11 Nov 11	W7C30-16-14	.500in	.438in	3.7	1.8	7.3		Clearance Diam.:		34.83mm		
09 Feb 07	W7C30-16-11.27mm	.500in	11.27mm	3.7	1.8	7.3		Clearance Diam.:		34.83mm		
	W7C30-16-12mm	.500in	12.00mm	3.7	1.8	7.3		Clearance Diam.:		34.83mm		
09 Mar 88	W7C30-16-16	.500in	.500in	3.7	1.8	7.3		Clearance Diam.:		34.83mm		
01 Jul 04	W7C30-13mm-10mm	*13.00mm	10.00mm	3.9	1.9	7.7		Clearance Diam.:		34.83mm		
02 May 88	W7C30-13mm-12mm	*13.00mm	12.00mm	3.9	1.9	7.7		Clearance Diam.:		34.83mm		
08 Sep 00	W7C30-14mm-6mm	*14.00mm	6.00mm	3.9	1.9	7.7		Clearance Diam.:		34.83mm		
	W7C30-14mm-8mm	*14.00mm	8.00mm	3.9	1.9	7.7		Clearance Diam.:		34.83mm		
	W7C30-14mm-9mm	*14.00mm	9.00mm	3.9	1.9	7.7		Clearance Diam.:		34.83mm		
	W7C30-14mm-12	*14.00mm	.375in	3.9	1.9	7.7		Clearance Diam.:		34.83mm		
	W7C30-14mm-10mm	*14.00mm	10.00mm	3.9	1.9	7.7		Clearance Diam.:		34.83mm		
	W7C30-14mm-11mm	*14.00mm	11.00mm	3.9	1.9	7.7		Clearance Diam.:		34.83mm		
12 Oct 01	W7C30-14mm-14	*14.00mm	.438in	3.9	1.9	7.7		Clearance Diam.:		34.83mm		
03 Nov 88	W7C30-14mm-12mm	*14.00mm	12.00mm	3.9	1.9	7.7		Clearance Diam.:		34.83mm		
24 May 05	W7C30-14mm-13mm	*14.00mm	*13.00mm	3.9	1.9	7.7		Clearance Diam.:		34.83mm		
27 Jul 88	W7C30-14mm-14mm	*14.00mm	*14.00mm	3.9	1.9	7.7		Clearance Diam.:		34.83mm		
04 Apr 00	W7C30-15mm-6mm	*15.00mm	6.00mm	3.9	1.9	7.7		Clearance Diam.:		34.83mm		
09 Oct 00	W7C30-15mm-7.5mm	*15.00mm	7.50mm	3.9	1.9	7.7		Clearance Diam.:		34.83mm		
09 Mar 88	W7C30-15mm-8mm	*15.00mm	8.00mm	3.9	1.9	7.7		Clearance Diam.:		34.83mm		
19 Sep 03	W7C30-15mm-9mm	*15.00mm	9.00mm	3.9	1.9	7.7		Clearance Diam.:		34.83mm		
	W7C30-15mm-10mm	*15.00mm	10.00mm	3.9	1.9	7.7		Clearance Diam.:		34.83mm		
02 Aug 00	W7C30-15mm-11mm	*15.00mm	11.00mm	3.9	1.9	7.7		Clearance Diam.:		34.83mm		
	W7C30-15mm-12mm	*15.00mm	12.00mm	3.9	1.9	7.7		Clearance Diam.:		34.83mm		
21 Apr 03	W7C30-15mm-16	*15.00mm	.500in	3.9	1.9	7.7		Clearance Diam.:		34.83mm		
18 Apr 05	W7C30-15mm-14mm	*15.00mm	*14.00mm	3.9	1.9	7.7		Clearance Diam.:		34.83mm		

\* NOTE: Bores greater than 12.70mm Dia: bore depth is 1.00mm

NOTICE: THE INFORMATION AND DATA CONTAINED HEREIN IS CONSIDERED PROPRIETARY TO HELICAL PRODUCTS COMPANY, AND SHALL REMAIN THE EXCLUSIVE PROPERTY OF HELICAL. THE HOLDER WILL ASSUME CUSTODY AND CONTROL THAT THIS DOCUMENT WILL NOT BE COPIED, REPRODUCED OR DISCLOSED WITHOUT THE EXPRESS WRITTEN CONSENT OF HELICAL. POSSESSION OF THIS DOCUMENT DOES NOT CONSTITUTE A GRANT TO MANUFACTURE ANY ITEMS.

**ADDITIONAL BORE SIZES AVAILABLE UPON REQUEST**

APPROVALS	DATE	HELICAL PRODUCTS CO.	
DRAWN		P.O. BOX 1069 SANTA MARIA, CA. 93456 U.S.A PHONE (805) 928-3851 FSCI3201	
CHECKED		TITLE HELICAL FLEXIBLE SHAFT COUPLING	
PRODN		<b>TABULATED BORE SIZES</b>	
ISSUED	6/15/2012 9:54:54 AM	DWG NO	W7C30

Printed 6/15/2012 9:57:18 AM by Larryvg

ADDITION DATE	PART NUMBER	BORE TOLERANCES		TORQUES ( Nm )			TORSIONAL FLEXIBILITY deg/Nm	MASS MOMENT OF INERTIA	COMMENTS	A1		A2	
		+0.002in -0.000in	or +0.05mm -0.00mm	Non-reversing	Shock or Reversing	Momentary				A1	A2		
												A1 Dia	A2 Dia
09 Mar 88	W7C30-15mm-15mm	*15.00mm	*15.00mm	3.9	1.9	7.7			Clearance Diam.:	34.83mm			
09 Mar 88	W7C30-20-9mm	*.625in	9.00mm	3.9	1.9	7.7			Clearance Diam.:	34.83mm			
	W7C30-20-12	*.625in	.375in	3.9	1.9	7.7			Clearance Diam.:	34.83mm			
	W7C30-20-10mm	*.625in	10.00mm	3.9	1.9	7.7			Clearance Diam.:	34.83mm			
21 Jan 11	W7C30-16mm-5mm	*16.00mm	5.00mm	3.9	1.9	7.7			Clearance Diam.:	34.83mm			
15 Jan 01	W7C30-16mm-6mm	*16.00mm	6.00mm	3.9	1.9	7.7			Clearance Diam.:	34.83mm			
02 Aug 06	W7C30-16mm-8mm	*16.00mm	8.00mm	3.9	1.9	7.7			Clearance Diam.:	34.83mm			
	W7C30-16mm-9mm	*16.00mm	9.00mm	3.9	1.9	7.7			Clearance Diam.:	34.83mm			
	W7C30-16mm-10mm	*16.00mm	10.00mm	3.9	1.9	7.7			Clearance Diam.:	34.83mm			
	W7C30-16mm-11mm	*16.00mm	11.00mm	3.9	1.9	7.7			Clearance Diam.:	34.83mm			
	W7C30-16mm-12mm	*16.00mm	12.00mm	3.9	1.9	7.7			Clearance Diam.:	34.83mm			
09 Mar 88	W7C30-16mm-14mm	*16.00mm	*14.00mm	3.9	1.9	7.7			Clearance Diam.:	34.83mm			
02 May 88	W7C30-16mm-15mm	*16.00mm	*15.00mm	3.9	1.9	7.7			Clearance Diam.:	34.83mm			
09 Mar 88	W7C30-16mm-16mm	*16.00mm	*16.00mm	3.9	1.9	7.7			Clearance Diam.:	34.83mm			
	W7C30-17mm-6mm	*17.00mm	6.00mm	3.9	1.9	7.7			Clearance Diam.:	34.83mm			
09 Mar 88	W7C30-17mm-15mm	*17.00mm	*15.00mm	3.9	1.9	7.7			Clearance Diam.:	34.83mm			
29 APR 14	W7C30-14mm-8	*14.00mm	.250in	3.9	1.9	7.7			Clearance Diameter:	34.83mm			
05 AUG 14	W7C30-13mm-11mm	*13.00mm	11.00mm	3.9	1.9	7.7			Clearance Diameter:	34.83mm			
25 NOV 14	W7C30-18-8mm	*.563in	8.00mm	3.9	1.9	7.7			Clearance Diameter:	34.83mm			
02 DEC 14	W7C30-12.5mm-11mm	12.50mm	11.00mm	3.9	1.9	7.7			Clearance Diameter:	34.83mm			
26 JUL 16	W7C30-14mm-4mm	14.00mm	4.00mm	3.9	1.9	7.7			Clearance Diameter:	34.83mm			

\* NOTE: Bores greater than 12.70mm Dia: bore depth is 1.00mm

NOTICE: THE INFORMATION AND DATA CONTAINED HEREIN IS CONSIDERED PROPRIETARY TO HELICAL PRODUCTS COMPANY, AND SHALL REMAIN THE EXCLUSIVE PROPERTY OF HELICAL. THE HOLDER WILL ASSUME CUSTODY AND CONTROL THAT THIS DOCUMENT WILL NOT BE COPIED, REPRODUCED OR DISCLOSED WITHOUT THE EXPRESS WRITTEN CONSENT OF HELICAL. POSSESSION OF THIS DOCUMENT DOES NOT CONSTITUTE A GRANT TO MANUFACTURE ANY ITEMS.

**ADDITIONAL BORE SIZES AVAILABLE UPON REQUEST**

APPROVALS	DATE	HELICAL PRODUCTS CO. P.O. BOX 1069 SANTA MARIA, CA. 93456 U.S.A PHONE (805) 928-3851 FSCI3201 <b>HELICAL FLEXIBLE SHAFT COUPLING</b> <b>TABULATED BORE SIZES</b> DWG NO W7C30
DRAWN		
CHECKED		
PRODN		
ISSUED	6/15/2012 9:54:54 AM	