

NOTES: See Tabulated Sheet

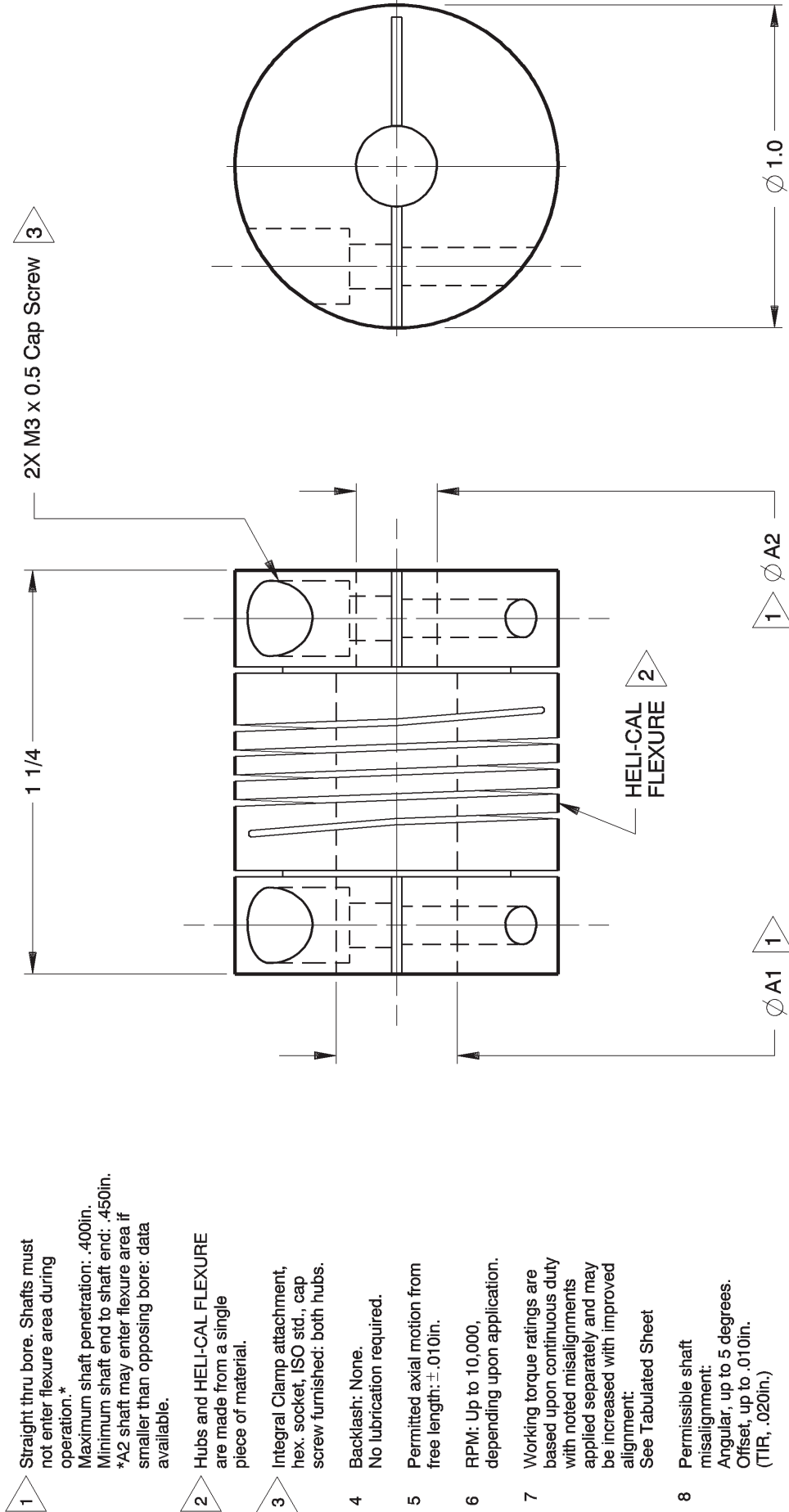

ACM100-12-8 SHOWN

- 1 Straight thru bore. Shafts must not enter flexure area during operation.*
- 2 Hubs and HELI-CAL FLEXURE are made from a single piece of material.
- 3 Integral Clamp attachment, hex. socket, ISO std., cap screw furnished: both hubs.
- 4 Backlash: None. No lubrication required.
- 5 Permitted axial motion from free length: ±.010in.
- 6 RPM: Up to 10,000, depending upon application.
- 7 Working torque ratings are based upon continuous duty with noted misalignments applied separately and may be increased with improved alignment: See Tabulated Sheet
- 8 Permissible shaft misalignment: Angular, up to 5 degrees. Offset, up to .010in. (TIR, .020in.)
- 9 Part will have a 1.136in. Clearance Diameter on both ends when any bore is over .444in. thru .588in.

NOTICE: THE INFORMATION AND DATA CONTAINED HEREIN IS CONSIDERED PROPRIETARY TO HELICAL PRODUCTS COMPANY, AND SHALL REMAIN THE EXCLUSIVE PROPERTY OF HELICAL. THE HOLDER WILL ASSUME CUSTODY AND CONTROL THAT THIS DOCUMENT WILL NOT BE COPIED, REPRODUCED OR DISCLOSED WITHOUT THE EXPRESS WRITTEN CONSENT OF HELICAL. POSSESSION OF THIS DOCUMENT DOES NOT CONSTITUTE A GRANT TO MANUFACTURE ANY ITEMS.

DO NOT SCALE DRAWING.

12-18-09

Finish was Chromic Acid Anodize; Updated GD&T

JAJ

2-25-99

Clerical format update/ No revision

MC

DATE

REVISION

CHK

Unless otherwise noted dimensions in inches.
 Inch Fractions: ± 1/64
 Decimals: .XX ±.010
 .XXX ±.005
 .XXXX ±.0010
 Metric Decimals: X ± 0.5mm
 X.X ± 0.25mm
 X.XX ± 0.15mm
 Angles: ± 2 degrees
 Break sharp corners .010 max.

APPROVALS	DATE
DRAWN MM	3-20-79
CHECKED MC	3-20-79
PRODN APA	3-20-79
ISSUED	
WEIGHT	39g (calc)
SCALE	2/1
SIZE	A

HELICAL PRODUCTS CO. SANTA MARIA, CA. 93456 U.S.A PHONE (805) 928-3851 FSC13201	
TITLE	HELICAL FLEXIBLE SHAFT COUPLING
MATERIAL	7075-T6 Aluminum Alloy
FINISH	Anodize per HPS1000
DWG NO	ACM100

ADDITION DATE	PART NUMBER	BORE TOLERANCES		TORQUES (lbin)			TORSIONAL FLEXIBILITY deg/lbin	MASS MOMENT OF INERTIA	COMMENTS	
		+002in -000in	+05mm -00mm	Non-reversing	Shock or Reversing	Momentary				
										A1 Dia
09 Mar 88	ACM100-12-8	.375in	.250in	14	7	28			A1	A2
09 Mar 88	ACM100-12-10	.375in	.313in	14	7	28				
09 Mar 88	ACM100-12-8mm	.375in	8.00mm	14	7	28				
09 Mar 88	ACM100-12-12	.375in	.375in	14	7	28				
10 May 11	ACM100-10mm-3mm	*10.00mm	3.00mm	14	7	28				
05 Jul 12	ACM100-10mm-4mm	*10.00mm	4.00mm	14	7	28				
20 May 88	ACM100-10mm-6mm	*10.00mm	6.00mm	14	7	28				
20 Jul 01	ACM100-10mm-8	*10.00mm	.250in	14	7	28				
	ACM100-10mm-6.4mm	*10.00mm	6.40mm	14	7	28				
	ACM100-10mm-6.48mm	*10.00mm	6.48mm	14	7	28				
01 Oct 07	ACM100-10mm-6.5mm	*10.00mm	6.50mm	14	7	28				
05 Dec 02	ACM100-10mm-10	*10.00mm	.313in	14	7	28				
	ACM100-10mm-12	*10.00mm	.375in	14	7	28				
09 Mar 88	ACM100-10mm-10mm	*10.00mm	*10.00mm	14	7	28				
10 Jan 01	ACM100-11mm-6mm	*11.00mm	6.00mm	14	7	28				
	ACM100-11mm-11mm	*11.00mm	*11.00mm	14	7	28				
10 May 11	ACM100-12mm-3mm	*12.00mm	3.00mm	14	7	28				Clearance Diam.: 1.136in
	ACM100-12mm-6mm	*12.00mm	6.00mm	14	7	28				Clearance Diam.: 1.136in
	ACM100-12mm-8	*12.00mm	.250in	14	7	28				Clearance Diam.: 1.136in
06 Aug 10	ACM100-12mm-6.5mm	*12.00mm	6.50mm	14	7	28				Clearance Diam.: 1.136in
	ACM100-12mm-8mm	*12.00mm	8.00mm	14	7	28				Clearance Diam.: 1.136in
06 Aug 10	ACM100-12mm-8.5mm	*12.00mm	8.50mm	14	7	28				Clearance Diam.: 1.136in
20 May 88	ACM100-12mm-12	*12.00mm	.375in	14	7	28				Clearance Diam.: 1.136in
	ACM100-12mm-10mm	*12.00mm	*10.00mm	14	7	28				Clearance Diam.: 1.136in
	ACM100-12mm-11mm	*12.00mm	*11.00mm	14	7	28				Clearance Diam.: 1.136in
09 Mar 88	ACM100-12mm-12mm	*12.00mm	*12.00mm	14	7	28				Clearance Diam.: 1.136in
05 Aug 02	ACM100-16-6mm	*.500in	6.00mm	14	7	28				Clearance Diam.: 1.136in
06 Aug 10	ACM100-12.8mm-6mm	*12.80mm	6.00mm	14	7	28				Clearance Diam.: 1.136in
06 Aug 10	ACM100-12.8mm-6.5mm	*12.80mm	6.50mm	14	7	28				Clearance Diam.: 1.136in
29 Nov 10	ACM100-12.8mm-8mm	*12.80mm	8.00mm	14	7	28				Clearance Diam.: 1.136in
29 Nov 10	ACM100-12.8mm-8.5mm	*12.80mm	8.50mm	14	7	28				Clearance Diam.: 1.136in

*** NOTE: Bore depth is .310in**

HELICAL PRODUCTS CO.
SANTA MARIA, CA, 93456 U.S.A
PHONE (805) 928-3851/FSCI3201

TITLE HELICAL FLEXIBLE SHAFT COUPLING

TABULATED BORE SIZES

DWG NO ACM100

APPROVALS DATE

DRAWN

CHECKED

PRODN

ISSUED 7/5/2012 12:22:24 PM

NOTICE: THE INFORMATION AND DATA CONTAINED HEREIN IS CONSIDERED PROPRIETARY TO HELICAL PRODUCTS COMPANY, AND SHALL REMAIN THE EXCLUSIVE PROPERTY OF HELICAL. THE HOLDER WILL ASSUME CUSTODY AND CONTROL THAT THIS DOCUMENT WILL NOT BE COPIED, REPRODUCED OR DISCLOSED WITHOUT THE EXPRESS WRITTEN CONSENT OF HELICAL. POSSESSION OF THIS DOCUMENT DOES NOT CONSTITUTE A GRANT TO MANUFACTURE ANY ITEMS.

ADDITIONAL BORE SIZES AVAILABLE UPON REQUEST

ADDITION DATE	PART NUMBER	BORE TOLERANCES		TORQUES (lb.in)			TORSIONAL FLEXIBILITY	MASS MOMENT OF INERTIA	COMMENTS	
		+0.002in -0.000in	+0.05mm or -0.00mm	A1 Dia	A2 Dia	Non-reversing			Shock or Reversing	Momentary
20 Feb 02	ACM100-14mm-6mm	*14.00mm	6.00mm	14	7	28			1.136in	Clearance Diam.:
16 Mar 00	ACM100-14mm-8	*14.00mm	.250in	14	7	28			1.136in	Clearance Diam.:
24 Apr 01	ACM100-14mm-8mm	*14.00mm	8.00mm	14	7	28			1.136in	Clearance Diam.:
15 Mar 17	ACM100-10mm-7mm	10.00mm	7.00mm	14	7	28				
9 JAN 18	ACM100-11mm-5mm	11.00mm	5.00mm	14	7	28				
13 Sept 18	ACM100-8-4	.250in	.125in	18	9	36				
13 Sept 18	ACM100-8-4mm	.250in	4.00mm	18	9	36				
13 Sept 18	ACM100-12-4.5mm	.375in	4.50mm	14	7	28				
13 Sept 18	ACM100-12-8mm	.375in	8.00mm	14	7	28				
13 Sept 18	ACM100-16-12mm	.500in	12.00mm	14	7	28				Clearance Diam.:
14 Sept 18	ACM100-3mm-2.3mm	3.00mm	2.30mm	20	10	40				
14 Sept 18	ACM100-4-3mm	.125in	3.00mm	19	9	37				
14 Sept 18	ACM100-5mm-2.3mm	5.00mm	2.30mm	18	9	36				
14 Sept 18	ACM100-5mm-4	5.00mm	.125in	18	9	36				
18 Sept 18	ACM100-4-4	.125in	.125in	19	9	37				

*** NOTE: Bores greater than .375in Dia: bore depth is .310in**

HELIICAL PRODUCTS CO.
 SANTA MARIA, CA, 93456 U.S.A
 PHONE (805) 928-3851/FSCI3201

TITLE HELICAL FLEXIBLE SHAFT COUPLING
TABULATED BORE SIZES

DWG NO ACM100

APPROVALS	DATE
DRAWN	
CHECKED	
PRODN	
ISSUED	7/5/2012 12:22:24 PM

NOTICE: THE INFORMATION AND DATA CONTAINED HEREIN IS CONSIDERED PROPRIETARY TO HELICAL PRODUCTS COMPANY, AND SHALL REMAIN THE EXCLUSIVE PROPERTY OF HELICAL. THE HOLDER WILL ASSUME CUSTODY AND CONTROL THAT THIS DOCUMENT WILL NOT BE COPIED, REPRODUCED OR DISCLOSED WITHOUT THE EXPRESS WRITTEN CONSENT OF HELICAL. POSSESSION OF THIS DOCUMENT DOES NOT CONSTITUTE A GRANT TO MANUFACTURE ANY ITEMS.

ADDITIONAL BORE SIZES AVAILABLE UPON REQUEST