

NOTES: See Tabulated Sheet

- 1 Straight thru bore. Shafts must not enter flexure area during operation.*
Maximum shaft penetration: .450in.
Minimum shaft end to shaft end: .600in.
*A2 shaft may enter flexure area if smaller than opposing bore: data available.
- 2 Hubs and HELI-CAL FLEXURE are made from a single piece of material.
- 3 Integral Clamp attachment, hex. socket, ISO std., cap screw furnished: both hubs.
- 4 Backlash: None.
No lubrication required.
- 5 Permitted axial motion from free length: ±.010in.
- 6 RPM: Up to 10,000, depending upon application.
- 7 Working torque ratings are based upon continuous duty with noted misalignments applied separately and may be increased with improved alignment:
See Tabulated Sheet
- 8 Permissible shaft misalignment:
Angular, up to 5 degrees.
Offset, up to .010in.
(TIR, .020in.)
- 9 Part will have a 1.257in. Clearance Diameter on both ends when any bore is over .567in. thru .709in.

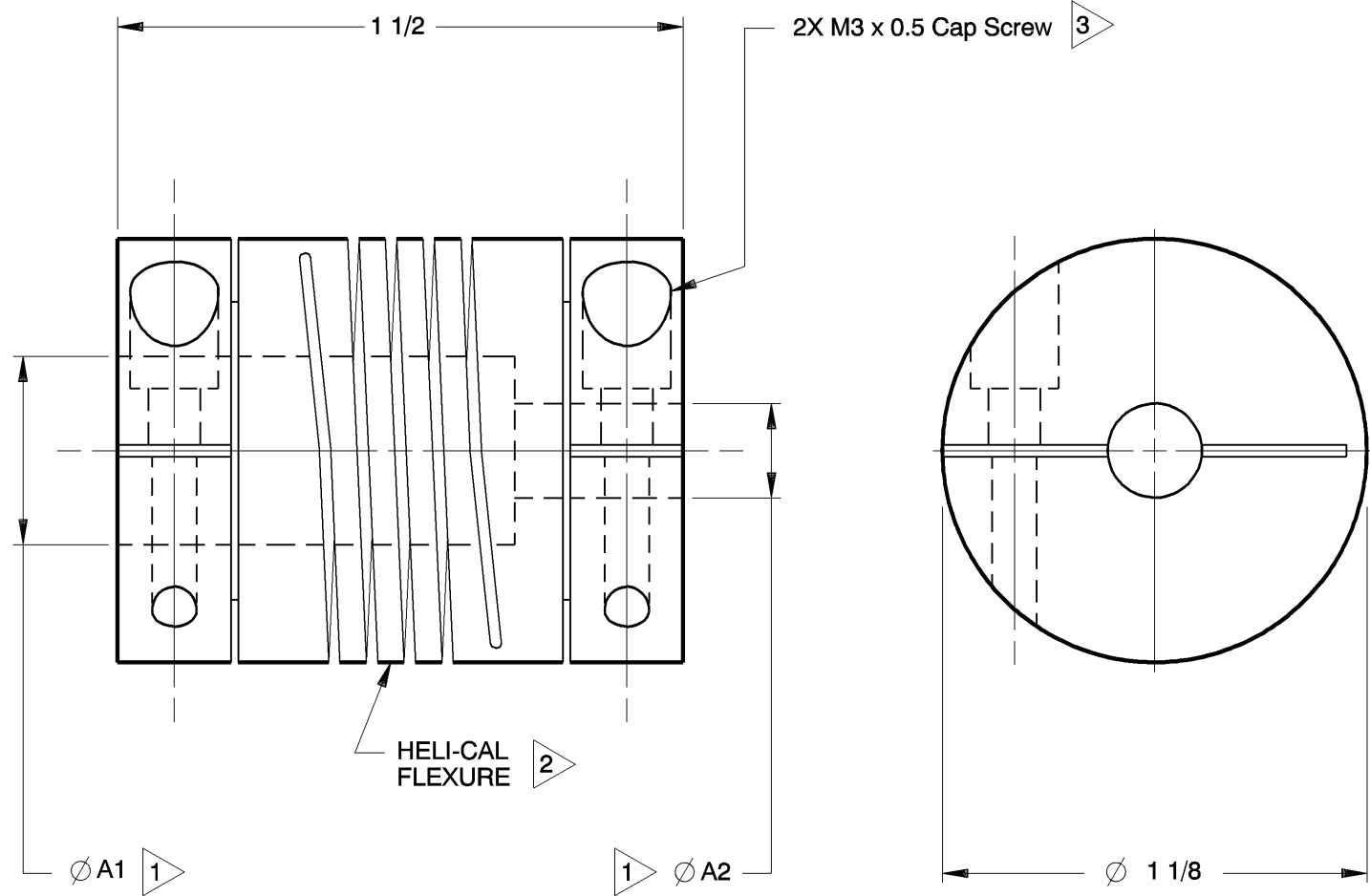

ACM112-16-8 SHOWN

NOTICE: THE INFORMATION AND DATA CONTAINED HEREIN IS CONSIDERED PROPRIETARY TO HELICAL PRODUCTS COMPANY, INC., AND SHALL REMAIN THE EXCLUSIVE PROPERTY OF HELICAL. THE HOLDER WILL ASSUME CUSTODY AND CONTROL THAT THIS DOCUMENT WILL NOT BE COPIED, REPRODUCED OR DISCLOSED WITHOUT THE EXPRESS WRITTEN CONSENT OF HELICAL. POSSESSION OF THIS DOCUMENT DOES NOT CONSTITUTE A GRANT TO MANUFACTURE ANY ITEMS.

DO NOT SCALE DRAWING.

12-18-09	---	Finish was Chromic Acid Anodize; Updated GD&T	HG	JAJ	Unless otherwise noted dimensions in inches. Inch Fractions: ± 1/64 Decimals: .XX ± .010 .XXX ± .005 .XXX ± .0010 Metric Decimals: X ± 0.5mm X.X ± 0.25mm X.XX ± 0.15mm Angles: ± 2 degrees Break sharp corners .010 max.	APPROVALS	DATE	HELICAL PRODUCTS CO., INC. P.O. BOX 1069 SANTA MARIA, CA. 93456 U.S.A PHONE (805) 928-3851 FSC13201			
						DRAWN	MM			10-12-79	
2-25-99		Clerical format update/ No revision	BJM	MC		CHECKED	MC	10-12-79	TITLE	HELICAL FLEXIBLE SHAFT COUPLING	
						ISSUED			MATERIAL	7075-T6 Aluminum Alloy	
DATE	LTR	REVISION	CHK			WEIGHT	57g (calc)	FINISH	Anodize per HPS1000		
						SCALE	2/1	SIZE	A	DWG NO	ACM112

ADDITION DATE	PART NUMBER	BORE TOLERANCES		TORQUES (lbin)			TORSIONAL FLEXIBILITY deg/lbin	MASS MOMENT OF INERTIA	COMMENTS	A1	A2	
		+.002in -.000in	or	+.05mm -.00mm	Non-reversing	Shock or Reversing						Momentary
		A1 Dia		A2 Dia								
	ACM112-3mm-3mm	3.00mm		3.00mm	24	12	48					
26 Aug 05	ACM112-5mm-5mm	5.00mm		5.00mm	33	17	66					
	ACM112-6mm-6mm	6.00mm		6.00mm	32	16	64					
09 Mar 88	ACM112-8-8	.250in		.250in	32	16	64					
	ACM112-8mm-4mm	8.00mm		4.00mm	28	14	56					
09 Mar 88	ACM112-8mm-8mm	8.00mm		8.00mm	28	14	56					
09 Mar 88	ACM112-12-6	.375in		.188in	24	12	48					
09 Mar 88	ACM112-12-6mm	.375in		6.00mm	24	12	48					
	ACM112-12-8	.375in		.250in	24	12	48					
09 Jan 08	ACM112-12-12	.375in		.375in	24	12	48					
	ACM112-10mm-3mm	10.00mm		3.00mm	24	12	48					
	ACM112-10mm-8	10.00mm		.250in	24	12	48					
18 May 88	ACM112-10mm-10mm	10.00mm		10.00mm	24	12	48					

*** NOTE: Bores greater than .512in Dia: bore depth is .450in**

NOTICE: THE INFORMATION AND DATA CONTAINED HEREIN IS CONSIDERED PROPRIETARY TO HELICAL PRODUCTS COMPANY, INC., AND SHALL REMAIN THE EXCLUSIVE PROPERTY OF HELICAL. THE HOLDER WILL ASSUME CUSTODY AND CONTROL THAT THIS DOCUMENT WILL NOT BE COPIED, REPRODUCED OR DISCLOSED WITHOUT THE EXPRESS WRITTEN CONSENT OF HELICAL. POSSESSION OF THIS DOCUMENT DOES NOT CONSTITUTE A GRANT TO MANUFACTURE ANY ITEMS.

ADDITIONAL BORE SIZES AVAILABLE UPON REQUEST

APPROVALS	DATE	HELICAL PRODUCTS CO. INC P.O. BOX 1069 SANTA MARIA, CA. 93456 U.S.A PHONE (805) 928-3851 FSCI3201
DRAWN		
CHECKED		
PRODN		
ISSUED	4/2/2012 10:39:17 AM	TITLE HELICAL FLEXIBLE SHAFT COUPLING TABULATED BORE SIZES DWG NO ACM112

Printed 4/2/2012 10:40:27 AM by Larryvg

ADDITION DATE	PART NUMBER	BORE TOLERANCES		TORQUES (lbin)			TORSIONAL FLEXIBILITY	MASS MOMENT OF INERTIA	COMMENTS	A1	A2	
		+.002in -.000in	or +.05mm -.00mm	Non-reversing	Shock or Reversing	Momentary						deg/lbin
	ACM112-11mm-7mm	11.00mm	7.00mm	22	11	44						
	ACM112-11mm-11mm	11.00mm	11.00mm	22	11	44						
12 Oct 89	ACM112-12mm-6mm	12.00mm	6.00mm	21	10	42						
	ACM112-12mm-8	12.00mm	.250in	21	10	42						
12 Oct 89	ACM112-12mm-8mm	12.00mm	8.00mm	21	10	42						
10 Jul 90	ACM112-12mm-12	12.00mm	.375in	21	10	42						
15 Jan 91	ACM112-12mm-12mm	12.00mm	12.00mm	21	10	42						
09 Mar 88	ACM112-16-8	.500in	.250in	20	10	40						
09 Mar 88	ACM112-16-12	.500in	.375in	20	10	40						
18 May 88	ACM112-16-12mm	.500in	12.00mm	20	10	40						
09 Mar 88	ACM112-16-16	.500in	.500in	20	10	40						
	ACM112-13mm-8mm	13.00mm	8.00mm	20	10	40						
	ACM112-14mm-6	*14.00mm	.188in	20	10	40						
21 May 02	ACM112-14mm-5mm	*14.00mm	5.00mm	20	10	40						
26 Jul 90	ACM112-14mm-6mm	*14.00mm	6.00mm	20	10	40						
22 Jan 91	ACM112-14mm-8	*14.00mm	.250in	20	10	40						
08 Aug 89	ACM112-14mm-8mm	*14.00mm	8.00mm	20	10	40						
	ACM112-14mm-10mm	*14.00mm	10.00mm	20	10	40						
	ACM112-14mm-11mm	*14.00mm	11.00mm	20	10	40						
08 Aug 89	ACM112-14mm-12mm	*14.00mm	12.00mm	20	10	40						
	ACM112-14mm-14mm	*14.00mm	*14.00mm	20	10	40						
12 Jan 01	ACM112-15mm-6mm	*15.00mm	6.00mm	20	10	40		Clearance Diam.:	1.257in			
	ACM112-15mm-8mm	*15.00mm	8.00mm	20	10	40		Clearance Diam.:	1.257in			
	ACM112-15mm-12	*15.00mm	.375in	20	10	40		Clearance Diam.:	1.257in			
	ACM112-15mm-10mm	*15.00mm	10.00mm	20	10	40		Clearance Diam.:	1.257in			
30 Dec 02	ACM112-15mm-12mm	*15.00mm	12.00mm	20	10	40		Clearance Diam.:	1.257in			
20 Dec 11	ACM112-15mm-16	*15.00mm	.500in	20	10	40		Clearance Diam.:	1.257in			
31 May 89	ACM112-15mm-15mm	*15.00mm	*15.00mm	20	10	40		Clearance Diam.:	1.257in			
15 Jan 91	ACM112-20-20	*.625in	*.625in	20	10	40		Clearance Diam.:	1.257in			
	ACM112-16mm-6mm	*16.00mm	6.00mm	20	10	40		Clearance Diam.:	1.257in			
18 May 88	ACM112-16mm-8mm	*16.00mm	8.00mm	20	10	40		Clearance Diam.:	1.257in			

* NOTE: Bores greater than .512in Dia: bore depth is .450in

NOTICE: THE INFORMATION AND DATA CONTAINED HEREIN IS CONSIDERED PROPRIETARY TO HELICAL PRODUCTS COMPANY, INC., AND SHALL REMAIN THE EXCLUSIVE PROPERTY OF HELICAL. THE HOLDER WILL ASSUME CUSTODY AND CONTROL THAT THIS DOCUMENT WILL NOT BE COPIED, REPRODUCED OR DISCLOSED WITHOUT THE EXPRESS WRITTEN CONSENT OF HELICAL. POSSESSION OF THIS DOCUMENT DOES NOT CONSTITUTE A GRANT TO MANUFACTURE ANY ITEMS.

ADDITIONAL BORE SIZES AVAILABLE UPON REQUEST

APPROVALS	DATE	HELICAL PRODUCTS CO. INC P.O. BOX 1069 SANTA MARIA, CA. 93456 U.S.A PHONE (805) 928-3851 FSCI3201
DRAWN		
CHECKED		TITLE
PRODN		HELICAL FLEXIBLE SHAFT COUPLING
ISSUED	4/2/2012 10:39:17 AM	DWG NO TABULATED BORE SIZES ACM112

Printed 4/2/2012 10:40:27 AM by larryvg

ADDITION DATE	PART NUMBER	BORE TOLERANCES		TORQUES (lbin)			TORSIONAL FLEXIBILITY deg/lbin	MASS MOMENT OF INERTIA	COMMENTS	A1	A2
		+0.002in -0.000in	or +0.05mm -0.00mm	Non-reversing	Shock or Reversing	Momentary					
02 Apr 12	ACM112-16mm-12	*16.00mm	.375in	20	10	40			Clearance Diam.:	1.257in	
	ACM112-16mm-10mm	*16.00mm	10.00mm	20	10	40			Clearance Diam.:	1.257in	
18 May 88	ACM112-16mm-12mm	*16.00mm	12.00mm	20	10	40			Clearance Diam.:	1.257in	
24 Apr 01	ACM112-16mm-14mm	*16.00mm	*14.00mm	20	10	40			Clearance Diam.:	1.257in	
18 May 88	ACM112-16mm-16mm	*16.00mm	*16.00mm	20	10	40			Clearance Diam.:	1.257in	

* NOTE: Bores greater than .512in Dia: bore depth is .450in

NOTICE: THE INFORMATION AND DATA CONTAINED HEREIN IS CONSIDERED PROPRIETARY TO HELICAL PRODUCTS COMPANY, INC., AND SHALL REMAIN THE EXCLUSIVE PROPERTY OF HELICAL. THE HOLDER WILL ASSUME CUSTODY AND CONTROL THAT THIS DOCUMENT WILL NOT BE COPIED, REPRODUCED OR DISCLOSED WITHOUT THE EXPRESS WRITTEN CONSENT OF HELICAL. POSSESSION OF THIS DOCUMENT DOES NOT CONSTITUTE A GRANT TO MANUFACTURE ANY ITEMS.

ADDITIONAL BORE SIZES AVAILABLE UPON REQUEST

APPROVALS	DATE	HELICAL PRODUCTS CO. INC P.O. BOX 1069 SANTA MARIA, CA. 93456 U.S.A PHONE (805) 928-3851 FSCI3201
DRAWN		
CHECKED		TITLE HELICAL FLEXIBLE SHAFT COUPLING
PRODN		TABULATED BORE SIZES
ISSUED	4/2/2012 10:39:17 AM	DWG NO ACM112

Printed 4/2/2012 10:40:27 AM by larryvg