

NOTES: See Tabulated Sheet

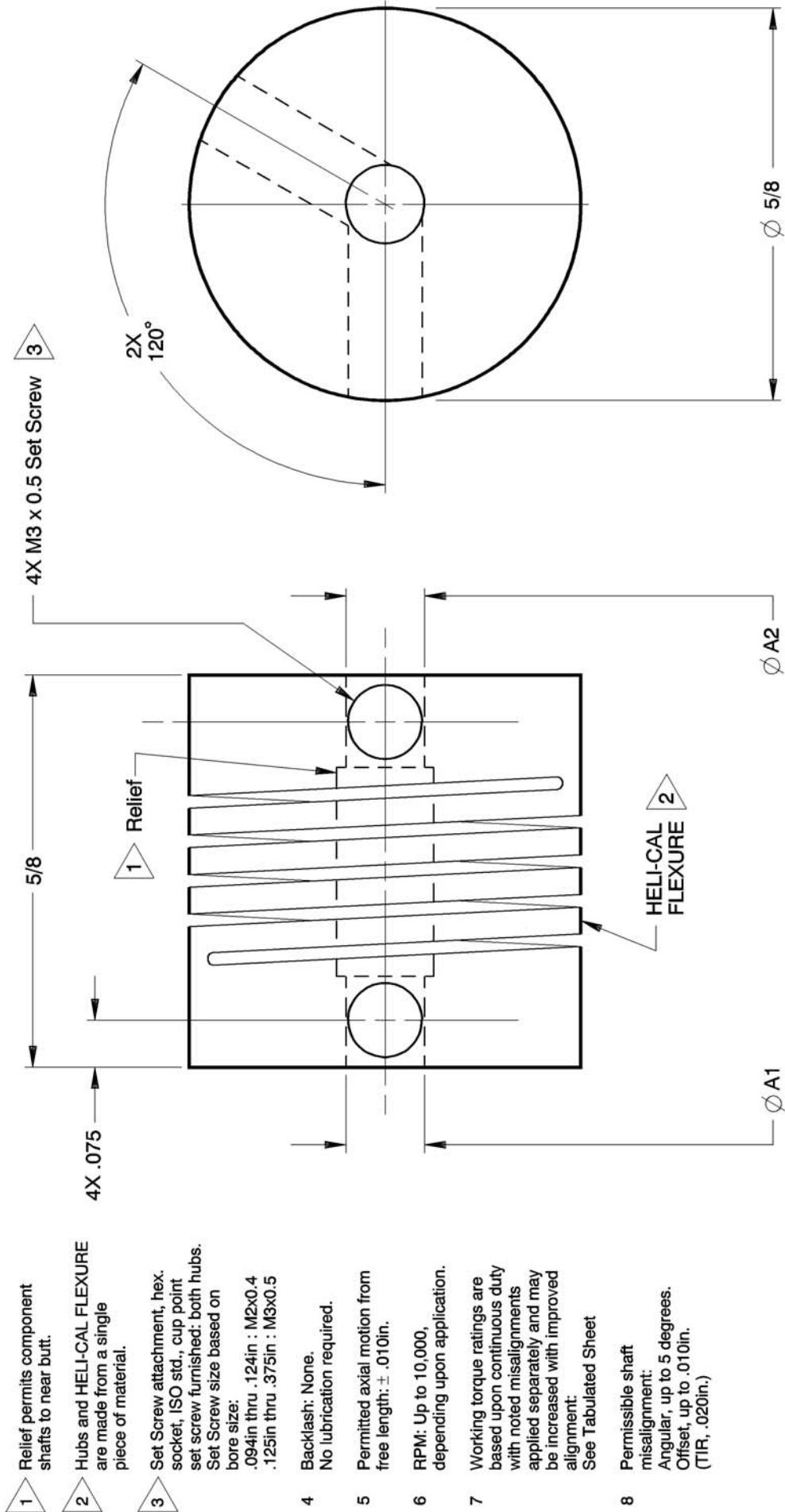

ARM062-4-4 SHOWN

<p>NOTICE: THE INFORMATION AND DATA CONTAINED HEREIN IS CONSIDERED PROPRIETARY TO HELICAL PRODUCTS COMPANY, INC., AND SHALL REMAIN THE EXCLUSIVE PROPERTY OF HELICAL. THE HOLDER WILL ASSUME CUSTODY AND CONTROL THAT THIS DOCUMENT WILL NOT BE COPIED, REPRODUCED OR DISCLOSED WITHOUT THE EXPRESS WRITTEN CONSENT OF HELICAL. POSSESSION OF THIS DOCUMENT DOES NOT CONSTITUTE A GRANT TO MANUFACTURE ANY ITEMS.</p> <p>DO NOT SCALE DRAWING.</p>		<p>12-18-09</p>	---	<p>Finish was Chromic Acid Anodize; Updated GD&T</p>	<p>JAJ</p>	<p>Unless otherwise noted dimensions in inches.</p> <p>Tolerances are: Fractions: ± 1/64 Decimals: .XX ± .010 .XXX ± .005 .XXXX ± .0010 Angles: ± 2 degrees Break sharp corners .010 max.</p>	<p>APPROVALS</p> <p>DRAWN MM</p> <p>CHECKED MC</p> <p>PRODN APA</p> <p>ISSUED</p>	<p>DATE</p> <p>1-3-80</p> <p>1-3-80</p> <p>1-3-80</p>	<p>HELICAL PRODUCTS CO., INC.</p> <p>P.O. BOX 1069 SANTA MARIA, CA. 93456 U.S.A</p> <p>PHONE (805) 928-3851 FSC13201</p>
<p>8-10-98</p>	<p>DATE</p>	<p>8-10-98</p>	<p>REVISION</p>	<p>BJM</p>	<p>CHK</p>	<p>WEIGHT 7g (calc)</p>	<p>TITLE</p> <p>HELICAL FLEXIBLE SHAFT COUPLING</p>	<p>MATERIAL</p> <p>7075-T6 Aluminum Alloy</p>	<p>FINISH</p> <p>Anodize per HPS1000</p>
<p>LTR</p>	<p>REVISION</p>	<p>DATE</p>	<p>REVISION</p>	<p>BJM</p>	<p>CHK</p>	<p>SCALE 4/1</p>	<p>SIZE A</p>	<p>DWG NO</p> <p>ARM062</p>	

ADDITION DATE	PART NUMBER	BORE TOLERANCES		TORQUES (lbin)			TORSIONAL FLEXIBILITY	MASS MOMENT OF INERTIA	COMMENTS
		+002in -000in	+05mm -00mm	Non-reversing	Shock or Reversing	Momentary			
		3.00mm	3.00mm	7	4	14			A1 A2
09 Mar 88	ARM062-3mm-3mm	.125in	.125in	7	3	14			
09 Mar 88	ARM062-4-4	.157in	.157in	6	3	12			
	ARM062-5-5	4.00mm	4.00mm	6	3	12			
	ARM062-4mm-4mm	.188in	.094in	5.0	2.5	10.0			
19 Sep 00	ARM062-6-3	.188in	2.50mm	5.0	2.5	10.0			
19 Sep 00	ARM062-6-2.5mm	.188in	.125in	5.0	2.5	10.0			
24 Jul 01	ARM062-6-4	.188in	.188in	5.0	2.5	10.0			
	ARM062-6-6	5.00mm	4.00mm	4.8	2.4	9.6			
25 Jul 00	ARM062-5mm-4mm	5.00mm	5.00mm	4.8	2.4	9.6			
	ARM062-5mm-5mm	* 6.00mm	4.00mm	5.0	2.5	10.0			
21 Jan 91	ARM062-6mm-4mm	* 6.00mm	5.00mm	5.0	2.5	10.0			
	ARM062-6mm-5mm	* 6.00mm	* 6.00mm	5.0	2.5	10.0			
27 Sep 90	ARM062-6mm-6mm	* .250in	* .250in	5.0	2.5	10.0			
	ARM062-8-8	.188in	.157in	5.0	2.5	10.0			
2 OCT 15	ARM062-6-5								

*** NOTE: Bores greater than .197in Dia: bore depth is .145in**

NOTICE: THE INFORMATION AND DATA CONTAINED HEREIN IS CONSIDERED PROPRIETARY TO HELICAL PRODUCTS COMPANY, INC., AND SHALL REMAIN THE EXCLUSIVE PROPERTY OF HELICAL. THE HOLDER WILL ASSUME CUSTODY AND CONTROL THAT THIS DOCUMENT WILL NOT BE COPIED, REPRODUCED OR DISCLOSED WITHOUT THE EXPRESS WRITTEN CONSENT OF HELICAL. POSSESSION OF THIS DOCUMENT DOES NOT CONSTITUTE A GRANT TO MANUFACTURE ANY ITEMS.

ADDITIONAL BORE SIZES AVAILABLE UPON REQUEST

APPROVALS	DATE	HELICAL PRODUCTS CO. INC
DRAWN		P.O. BOX 1069 SANTA MARIA, CA. 93456 U.S.A
CHECKED		PHONE (805) 928-3851/FSCI3201
PRODN		TITLE HELICAL FLEXIBLE SHAFT COUPLING
ISSUED	12/17/2009 11:56:19 PM	TABULATED BORE SIZES
		DWG NO ARM062