

NOTES: See Tabulated Sheet

1 Straight thru bore. Shafts must not enter flexure area during operation.\*  
 Maximum shaft penetration: .450in.  
 Minimum shaft end to shaft end: .600in.  
 \*A2 shaft may enter flexure area if smaller than opposing bore: data available.

2 Hubs and HELI-CAL FLEXURE are made from a single piece of material.

3 Integral Clamp attachment, hex. socket, ISO std., cap screw furnished: both hubs.

4 Backlash: None. No lubrication required.

5 Permitted axial motion from free length: ±.010in.

6 RPM: Up to 10,000, depending upon application.

7 Working torque ratings are based upon continuous duty with noted misalignments applied separately and may be increased with improved alignment:  
 See Tabulated Sheet

8 Permissible shaft misalignment:  
 Angular, up to 5 degrees. Offset, up to .010in. (TIR, .020in.)

9 Part will have a 1.257in. Clearance Diameter on both ends when any bore is over .567in. thru .709in.

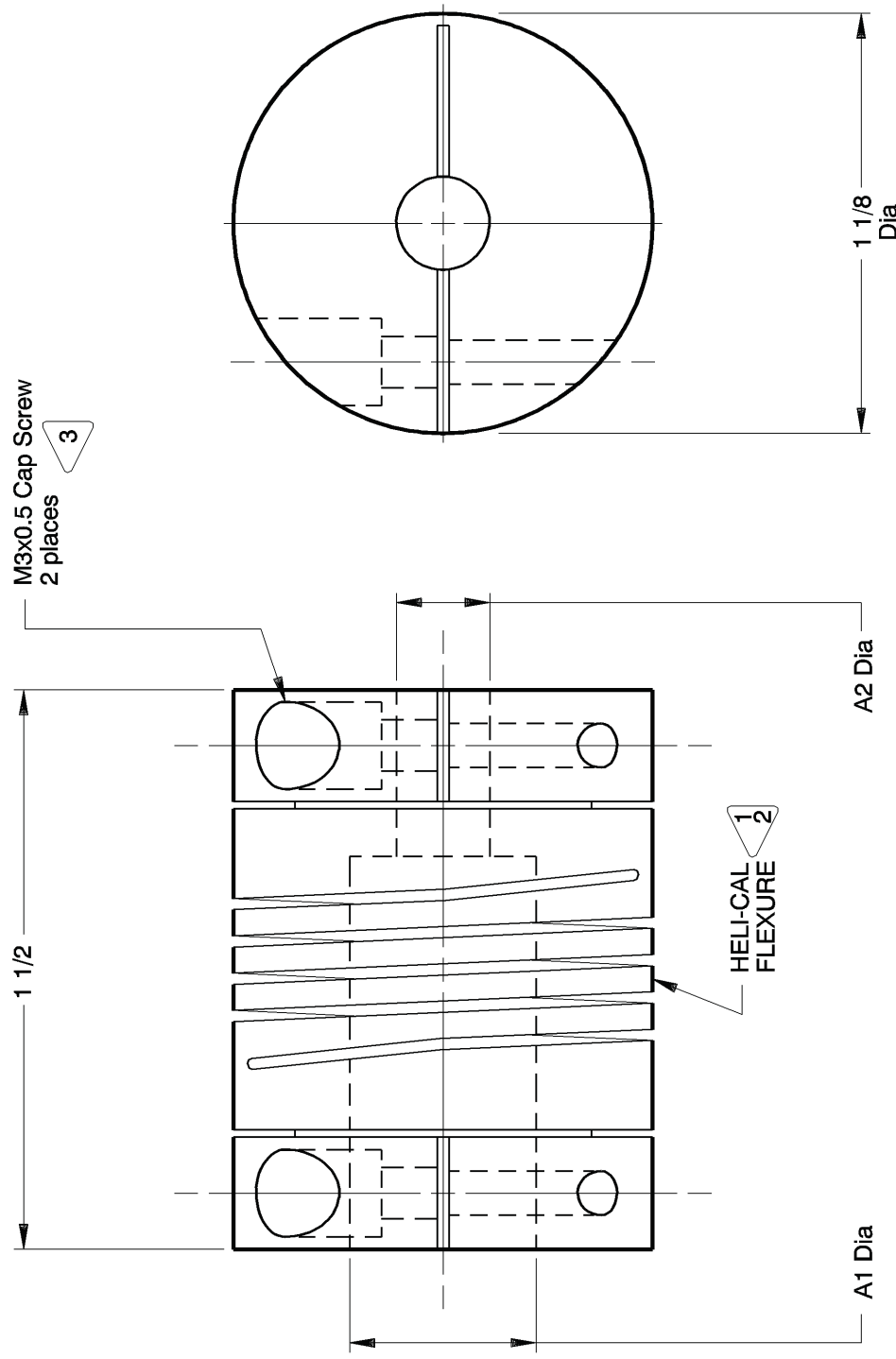

HCM112-16-8 SHOWN

NOTICE: THE INFORMATION AND DATA CONTAINED HEREIN IS CONSIDERED PROPRIETARY TO HELICAL PRODUCTS COMPANY, INC., AND SHALL REMAIN THE EXCLUSIVE PROPERTY OF HELICAL. THE HOLDER WILL ASSUME CUSTODY AND CONTROL THAT THIS DOCUMENT WILL NOT BE COPIED, REPRODUCED OR DISCLOSED WITHOUT THE EXPRESS WRITTEN CONSENT OF HELICAL. POSSESSION OF THIS DOCUMENT DOES NOT CONSTITUTE A GRANT TO MANUFACTURE ANY ITEMS.		APPROVALS DRAWN <b>JO</b> CHECKED <b>MC</b> PRODN <b>DH</b> ISSUED		DATE 1-21-87 6-5-87 7-12-88		HELICAL PRODUCTS CO., INC. P.O. BOX 1069 SANTA MARIA, CA. 93456 U.S.A. PHONE (805) 928-3851 FSC13201			
DO NOT SCALE DRAWING.		UNLESS OTHERWISE NOTED DIMENSIONS IN INCHES. Inch Fractions: ± 1/64 Decimals: .XX ±.00 .XXX ±.005 .XXXX ±.0010 Metric Decimals: X ± 0.5mm X.X ± 0.25mm X.XX ± 0.15mm		TITLE HELICAL FLEXIBLE SHAFT COUPLING		MATERIAL 17-4PH CRES		FINISH Natural	
Clerical format update/ No revision		BJM MC		WEIGHT 159g (calc)		HT		DWG NO HCM112	
DATE 2-25-99		LTR REVISION		SCALE 2/1		SIZE A		DWG NO HCM112	

ADDITION DATE	PART NUMBER	BORE TOLERANCES		TORQUES (lbin)			TORSIONAL FLEXIBILITY	MASS MOMENT OF INERTIA	COMMENTS
		A1 Dia	A2 Dia	Non-reversing	Shock or Reversing	Momentary			
		+0.002in -0.000in	+0.05mm -0.00mm						
21 May 02	HCM112-8mm-8mm	8.00mm	8.00mm	40	20	80			
	HCM112-10mm-10mm	10.00mm	10.00mm	34	17	68			
	HCM112-11mm-11mm	11.00mm	11.00mm	34	17	68			

**\* NOTE: Bore greater than .512in Dia: bore depth is .450in**

APPROVALS: DRAWN \_\_\_\_\_ DATE \_\_\_\_\_  
 CHECKED \_\_\_\_\_  
 PRODN \_\_\_\_\_  
 ISSUED \_\_\_\_\_

HELICAL PRODUCTS CO. INC  
 P.O. BOX 1069 SANTA MARIA, CA. 93456 U.S.A  
 PHONE (805) 928-3851/FSCI3201

TITLE: **HELICAL FLEXIBLE SHAFT COUPLING**  
**TABULATED BORE SIZES**  
 DWG NO: **HCM112**

**ADDITIONAL BORE SIZES AVAILABLE UPON REQUEST**

ADDITION DATE	PART NUMBER	BORE TOLERANCES		TORQUES (lbin)			TORSIONAL FLEXIBILITY	MASS MOMENT OF INERTIA	COMMENTS
		+002in -000in	+05mm -00mm	Non-reversing	Shock or Reversing	Momentary			
23 Mar 11	HCM112-12mm-12	12.00mm	.375in	31	16	63			
06 Nov 00	HCM112-12mm-10mm	12.00mm	10.00mm	31	16	63			
	HCM112-12mm-12mm	12.00mm	12.00mm	31	16	63			
01 Nov 00	HCM112-16-8	.500in	.250in	29	15	59			
20 May 88	HCM112-16-10	.500in	.313in	29	15	59			
01 Nov 00	HCM112-16-12	.500in	.375in	29	15	59			
	HCM112-16-12mm	.500in	12.00mm	29	15	59			
09 Mar 88	HCM112-16-16	.500in	.500in	29	15	59			
11 Jun 04	HCM112-14mm-5mm	*14.00mm	5.00mm	29	15	59			
22 Nov 06	HCM112-14mm-6mm	*14.00mm	6.00mm	29	15	59			
29 Jan 08	HCM112-14mm-8	*14.00mm	.250in	29	15	59			
30 Nov 89	HCM112-14mm-8mm	*14.00mm	8.00mm	29	15	59			
	HCM112-14mm-10mm	*14.00mm	10.00mm	29	15	59			
	HCM112-14mm-14mm	*14.00mm	*14.00mm	29	15	59			
23 Jul 02	HCM112-15mm-12	*15.00mm	.375in	29	15	59			Clearance Diam.: 1.257in
	HCM112-15mm-15mm	*15.00mm	*15.00mm	29	15	59			Clearance Diam.: 1.257in
21 Jul 11	HCM112-16mm-8	*16.00mm	.250in	29	15	59			Clearance Diam.: 1.257in
23 Jul 01	HCM112-16mm-8mm	*16.00mm	8.00mm	29	15	59			Clearance Diam.: 1.257in
07 Mar 07	HCM112-16mm-10mm	*16.00mm	10.00mm	29	15	59			Clearance Diam.: 1.257in
	HCM112-16mm-12mm	*16.00mm	12.00mm	29	15	59			Clearance Diam.: 1.257in
	HCM112-16mm-14mm	*16.00mm	*14.00mm	29	15	59			Clearance Diam.: 1.257in
	HCM112-16mm-16mm	*16.00mm	*16.00mm	29	15	59			Clearance Diam.: 1.257in
10 Sep 04	HCM112-17mm-10mm	*17.00mm	10.00mm	29	15	59			Clearance Diam.: 1.257in
10 Sep 04	HCM112-17mm-12.5mm	*17.00mm	12.50mm	29	15	59			Clearance Diam.: 1.257in
10 Sep 04	HCM112-17mm-16mm	*17.00mm	*16.00mm	29	15	59			Clearance Diam.: 1.257in
16 OCT 14	HCM112-14mm-7mm	*14.00mm	7.00mm	29	15	59			Clearance Diam.: 1.257in

APPROVALS		DATE	HELICAL PRODUCTS CO. INC
DRAWN			P.O. BOX 1069 SANTA MARIA, CA. 93456 U.S.A
CHECKED			PHONE (805) 928-3851/FSCI3201
PRODN			TITLE HELICAL FLEXIBLE SHAFT COUPLING
ISSUED		7/21/2011 2: 47: 38 PM	TABULATED BORE SIZES
			DWG NO HCM112

**\* NOTE: Bores greater than .512in Dia: bore depth is .450in**

NOTICE: THE INFORMATION AND DATA CONTAINED HEREIN IS CONSIDERED PROPRIETARY TO HELICAL PRODUCTS COMPANY, INC., AND SHALL REMAIN THE EXCLUSIVE PROPERTY OF HELICAL. THE HOLDER WILL ASSUME CUSTODY AND CONTROL THAT THIS DOCUMENT WILL NOT BE COPIED, REPRODUCED OR DISCLOSED WITHOUT THE EXPRESS WRITTEN CONSENT OF HELICAL. POSSESSION OF THIS DOCUMENT DOES NOT CONSTITUTE A GRANT TO MANUFACTURE ANY ITEMS.

**ADDITIONAL BORE SIZES AVAILABLE UPON REQUEST**